

OUTLINE DIMENSIONS

SOLDER/PLUG-IN TERMINAL STYLE

DIMENSIONS SHOWN IN INCHES & (MILLIMETERS).

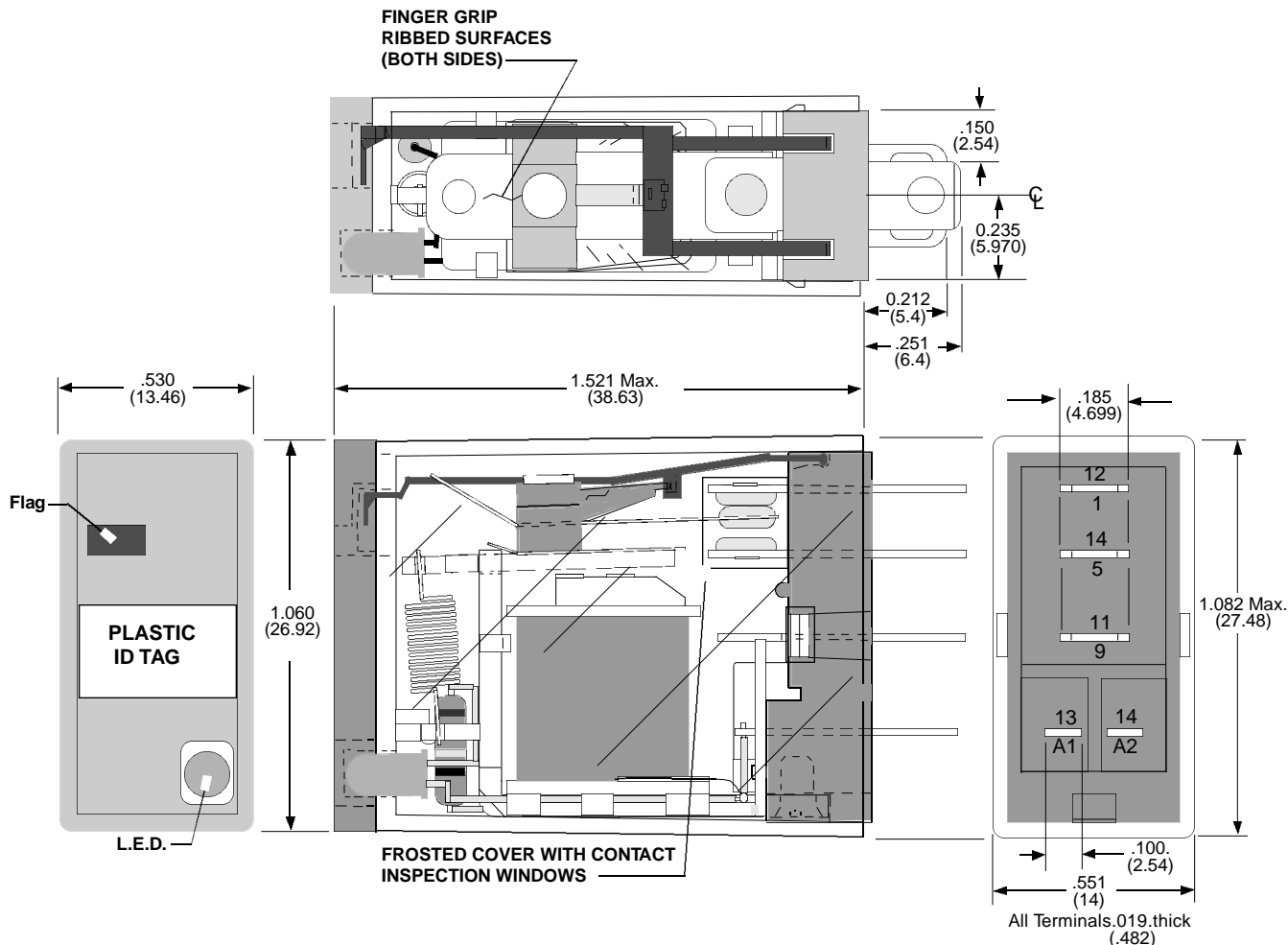

STANDARD PART NUMBERS	Coil measured @ 25°C		CROSS REFERENCE IDEC
	Nominal Input Voltage	Nominal Resistance (Ohms)	
AC COIL - SOLDER/PLUG-IN TERMINALS			
781XAXL-24A	24 VAC	300	RH1B-L-AC24V
781XAXL-120A	120 VAC	7680	RH1B-L-AC120V
781XAXL-220/230A	220/230 VAC	31,200	RH1B-L-AC220/240V
781XAXL-240A	240 VAC	31,200	RH1B-L-AC220/240V
AC COIL - PRINTED CIRCUIT TERMINALS			
781XAXTL-24A	24 VAC	300	RH1V2-U-AC24V
781XAXTL-120A	120 VAC	7680	RH1V2-U-AC120V
781XAXTL-220/230A	220/230 VAC	31,200	RH1V2-U-AC220/240V
781XAXTL-240A	240 VAC	31,200	RH1V2-U-AC220/240V
DC COIL - SOLDER/PLUG-IN TERMINALS			
781XAXL-6D	6 VDC	47	RH1B-L-DC6V
781XAXL-12D	12 VDC	188	RH1B-L-DC12V
781XAXL-24D	24 VDC	750	RH1B-L-DC24V
781XAXL-48D	48 VDC	2660	RH1B-L-DC48V
781XAXL-110D	110 VDC	13800	RH1B-L-DC110V
DC COIL - PRINTED CIRCUIT TERMINAL			
781XAXTL-12D	12 VDC	188	RH1V2-U-DC12V
781XAXTL-24D	24 VDC	750	RH1V2-U-DC24V
781XAXTL-110D	110 VDC	13800	RH1V2-U-DC110V

Magnecraft & Struthers-Dunn

ORDERING CODE 781 XAX C L-120A

Series: 12A (SPDT) Slim line midget relay with Flag Indicator & plastic I.D. tag.

Contact Arrangement: XAX (SPDT)

Terminal style: Solder/plug-in (Blade) terminals - No Code
Printed circuit terminals - Code T

Options:
Top Flange Adapter-Panel/DIN mount - Code C
Top or Bottom flange Adapter (Top mounted)- Code C1
Top or Bottom flange Adapter (Bottom mounted)- Code C1A

Standard Features: L.E.D. Lamp Indicator - Code L

Coil Voltage: 6, 12, 24, 120, 220/230 50 Hz, 240 Add "A" for VAC Coils
6, 12, 24, 48, 110 Add "D" for VDC Coils
AC COIL VOLTAGES ARE 50/60 Hz UNLESS OTHERWISE SPECIFIED