

SENSOR 59145 series

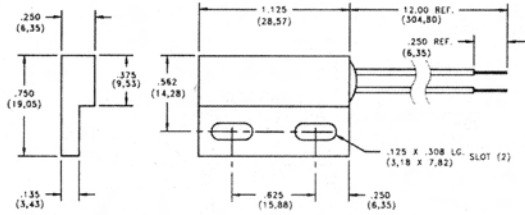

U.L. File# E61760 (N) ±0.010 (0,25) Tolerance

ACTUATOR 57145

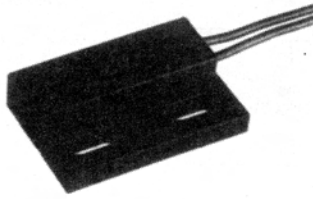
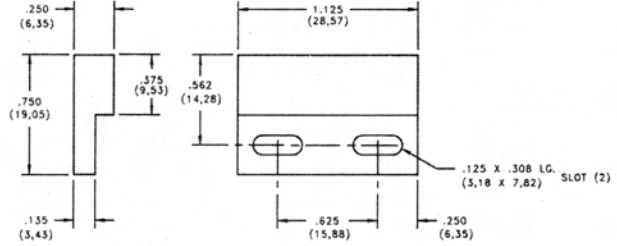
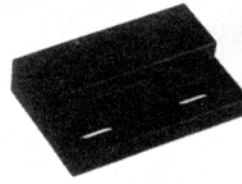

59160 series

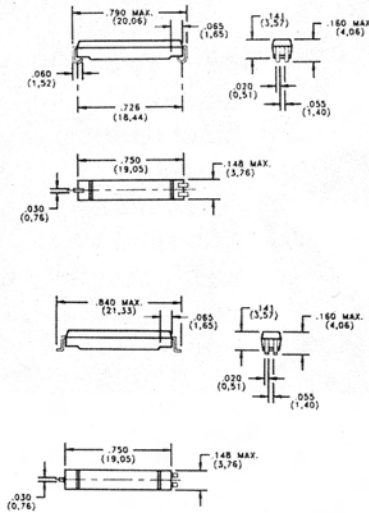

U.L. File# E61760 (N) ±0.010 (0,25) Tolerance

57050

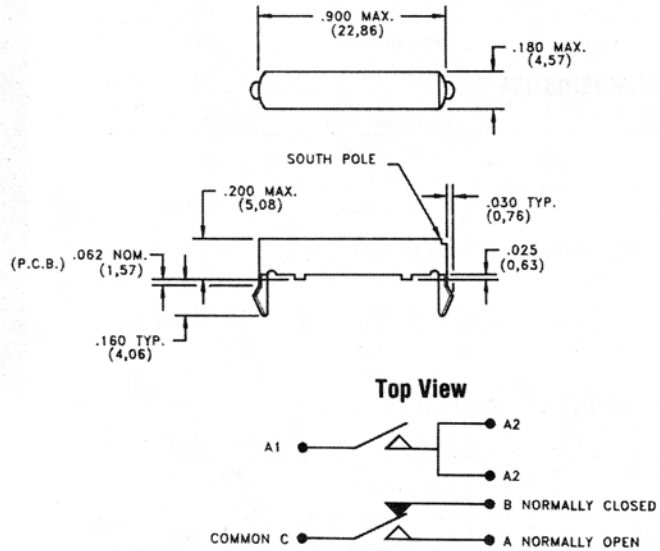

These notes apply only to sensors shown on this and the following page.

FLYING LEADS: 24AWG, 7/32, PVC, 105°C., 300V., UL1430 or UL1569.
Type -030 flying lead colors: common - white, normally open - black, normally closed - blue.

59160 NOTE: Surface mountable - 59160 meets all environmental and mounting requirements. Standard packaging is 8mm pitch on 32mm wide tape and reel.