

SS

Subminiature Basic Switch

Features

- Economical, subminiature basic switch offers long life (30 x 10⁶ operations)
- All models are free from overtravel restrictions, permit easy setting
- Wide switching capacity range from microvoltage/current loads (1 mA at 5 VDC) to high-capacity loads (10.1 A at 250 VAC)

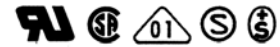
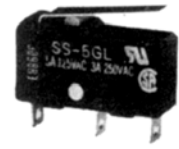

2

Ordering Information

Model number	Operating force g max.	Release force g min.	Pretravel mm (inch) max.	Overtravel mm (inch) min.	Movement differential mm (inch) max.	Operating position mm (inch) nom.	Actuator length mm (inch) nom.	Style
SS-01	150	25	0.5 (.020)	0.5 (.020)	0.1 (.004)	8.4 (.331)	—	
SS-01GL	50	6	1.2 (.047)	0.8 (.031)	13.6 (.535)	8.8 (.346)	14.5 (.571)	
SS-5	150	25	0.5 (.020)	0.5 (.020)	0.1 (.004)	8.4 (.331)	—	
SS-5GL	50	6	5.6 (.220)	1.2 (.047)	0.8 (.031)	8.8 (.346)	14.5 (.571)	
SS-5GL13	50	6	5.6 (.220)	1.2 (.047)	0.8 (.031)	10.7 (.421)	15.8 (.622)	
SS-5GL2	50	6	5.6 (.220)	1.2 (.047)	0.8 (.031)	14.5 (.571)	14.5 (.571)	
SS-10	150	25	0.6 (.024)	0.4 (.016)	0.12 (.005)	8.4 (.331)	—	
SS-10GL	50	6	1.0 (.039)	1.0 (.039)	13.6 (.535)	8.8 (.346)	14.5 (.571)	

Note: 1. All models above are solder terminal versions. Other available terminal versions are listed below.

Construction Data

Termination Solder terminal, quick connect terminal (#110), PCB terminal, and right/left angle terminal

Packaging method Trays with box

Dimensions [Unit: mm (inch)]

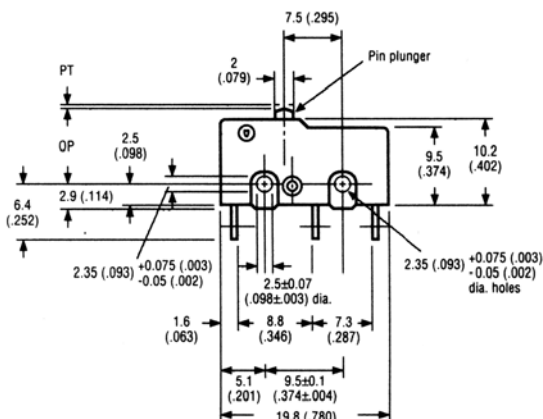

Actuators: Actuators are available in many special forms and lengths. OMRON offers standard type integral hinged lever and roller actuators. The length of the actuator is dimensioned from the centerline of the switch mounting hole as shown.

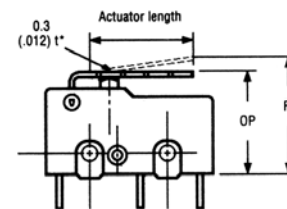
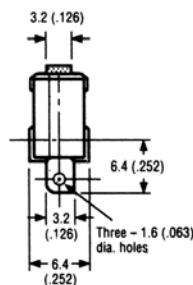

* Stainless steel lever

SWITCHES & KNOBS