

General Purpose Basic Switch

Features

- High precision basic switch in a variety of styles
- Wide margins of operating conditions increases the operating speed range
- Available in a variety of contact forms: basic, split contact, maintained contact, adjustable contact gap types
- UL listed, CSA certified



2 SWITCHES & KNOBS

Ordering Information

Model number	Operating force g max.	Release force g min.	Pretravel mm (inch) max.	Overtravel mm (inch) min.	Movement differential mm (inch) max.	Operating position mm (inch) nom.	Actuator length mm (inch) nom.	Style
Z-15G-B7-K	350	114	0.4 (.016)	0.13 (.005)	0.05 (.002)	15.9 (.626)	—	
Z-15GD-B7-K	350	114	0.4 (.016)	1.6 (.063)	0.05 (.002)	21.5 (.846)	—	
Z-15GQ-B7-K	350	114	0.4 (.016)	5.5 (.217)	0.05 (.002)	21.8 (.858)	—	
Z-15GQ21-B7-K	350	114	0.4 (.016)	3.58 (.129)	0.05 (.002)	33.4 (1.315)	—	
Z-15GQ22-B7-K	350	114	0.4 (.016)	3.58 (.129)	0.05 (.002)	33.4 (1.315)	—	
Z-15GW-B7-K	70	14	10.0 (.394)	5.6 (.220)	1.27 (.050)	19.0 (.748)	63.5 (2.500)	
Z-15GW2-B7-K	100	22	7.1 (.280)	4.0 (.157)	1.02 (.040)	30.2 (1.189)	48.5 (1.909)	
Z-15GW22-B7-K	160	42	2.7 (.106)	2.4 (.094)	0.5 (.020)	30.2 (1.189)	26.6 (1.047)	
Z-15GW55-B7-K	100	14	10.1 (.398)	5.6 (.220)	2.0 (.079)	19.0 (.748)	63.5 (2.500)	

Note: 1. All models above are screw terminal versions. Other available terminal versions are listed below.

Construction Data

Termination Screw terminal, solder terminal, and quick connect terminal (#250)

Packaging method Box

Dimensions [Unit: mm (inch)]

Actuators: Actuators are available in many special forms and lengths. OMRON offers standard type integral hinged lever and roller actuators. The length of the actuator is dimensioned from the centerline of the switch mounting hole as shown.

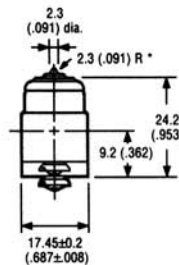
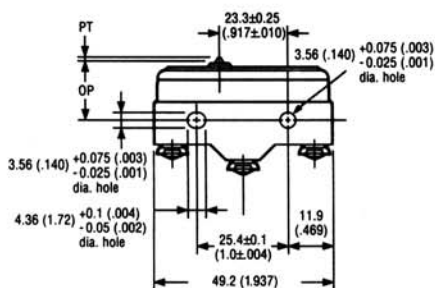

* Stainless steel plunger

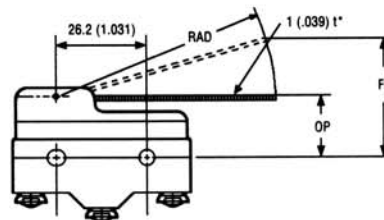

* Stainless steel lever