

Chip Carrier-Socket – PLCC (Surface mount)

IC Sockets – Stamped and formed contact version
For square plastic chip carrier of 1.27 mm / .050" pitch

Technical Data

Material

- Contact: Phosphor Bronze
- Surface of contact: 2 μm / 80 μ" nickel, 3 μm / 120 μ" tin
- Insulator: PPS, brown
LCP, white

Electrical

- Contact resistance: < 30 mΩ
- Insulation resistance: > 1000 MΩ
- Dielectric strength: 1000 Vac continuous for 1 minute
- Capacitance: Less than 1.0 pF at 1000 Hz
- Inductance self: 5.0 nH maximum at 500 KHz
- Inductance mutual: 1.0 nH maximum at 500 KHz

Mechanical

- Operating temperatures (continuous): PPS -55°C to +125°C
-67°F to +257°F
LCP -55°C to +230°C
-67°F to +446°F

Applications and Features

- Low profile design, only 4.50 mm / .175" high body
- Windows for solder joint inspection
- Stand-off's for easy cleaning
- High temperature plastic body to resist solder heat
- Polarized for correct orientation
- Also available Taped + Reel

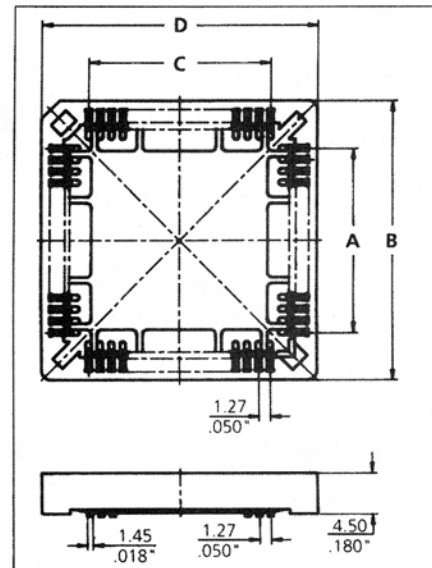
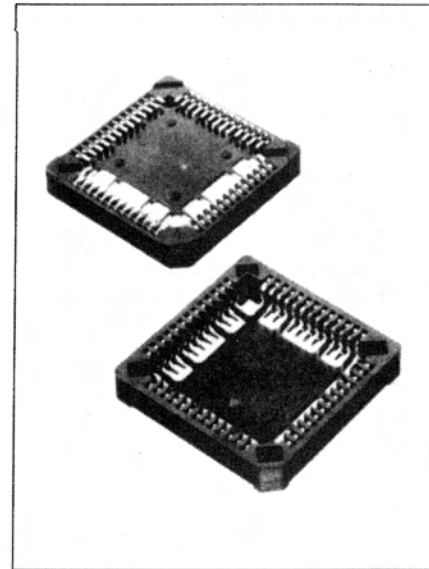

9 SOCKETS

How to order

Please replace 'X' with appropriate coding listed in the tables below

1 5 1 - X X X - 1 X - X 1

Number of Contacts

Definition	Code	A	B	C	D
20 contacts =	020	5.08 / .200"	15.58 / .613"	5.08 / .200"	15.58 / .613"
28 contacts =	028	7.62 / .300"	18.12 / .713"	7.62 / .300"	18.12 / .713"
32 contacts =	032	10.16 / .400"	20.66 / .813"	7.62 / .300"	18.12 / .713"
44 contacts =	044	12.70 / .500"	23.20 / .913"	12.70 / .500"	23.20 / .913"
52 contacts =	052	15.24 / .600"	25.74 / 1.013"	15.24 / .600"	25.74 / 1.013"
68 contacts =	068	20.32 / .800"	30.82 / 1.213"	20.32 / .800"	30.82 / 1.213"
84 contacts =	084	25.40 / 1.000"	35.90 / 1.413"	25.40 / 1.000"	35.90 / 1.413"

Packaging

Definition	Code
Tubes	= 1
Tape + Reel	= 2

Insulator/Plating

Definition/Code	Code
PPS/Tin	= 01
LCP/Tin	= 11