

Allows Inputs to be Jumped to Adjacent Sockets Without Additional Wiring.

- Infinite number of connections.
- Eliminates need to insert stripped jumper wires into terminals.
- Installs quickly.
- NO tools needed.



| Characteristics | 16-782CBJ-1 | 16-750/788CBJ-1 |
|--------------------------------|---------------------------------|---------------------------------|
| Description | Internal Coil Bus Jumper System | Internal Coil Bus Jumper System |
| Function | Wireless Socket Connection | Wireless Socket Connection |
| Packaging Minimum | 20 pieces | 20 pieces |
| Used with these Sockets | | |
| | 70-782EL8-1 (Sec. 2, p.14-15) | 70-750DL8-1 (Sec. 2, p.30-31) |
| | 70-782EL11-1 (Sec. 2, p.16-17) | 70-750DL11-1 (Sec. 2, p.30-31) |
| | 70-782EL14-1 (Sec. 2, p.18-19) | 70-750EL8-1 (Sec. 2, p.26-27) |
| | | 70-750EL11-1 (Sec. 2, p.26-27) |
| | | 70-788EL11-1 (Sec. 2, p.24-25) |



Coil Bus Jumpers colored green for better viewing.

16-782CBJ-1

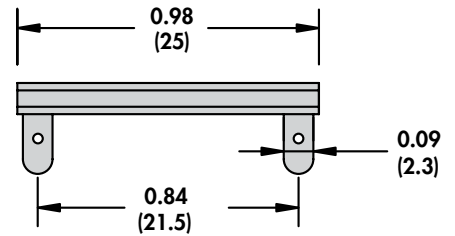
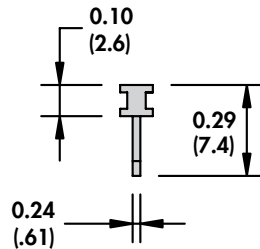

16-750/788CBJ-1

