

Standard terminal blocks

Screw clamp

DIN 1 - 3

A

1

End stop	th. 9 mm	BADL	V0	1SNA 399 903 R0200
End stop	th. 10 mm	BAM2	V2	1SNA 206 351 R1600
End stop	th. 10 mm	BAM2 V0	V0	1SNA 296 351 R0000
Rail	35 x 7,5 x 1	PR3.2Z		1SNA 174 300 R1700
Rail	35 x 15 x 2,3	PR4		1SNA 168 500 R1200
Rail	35 x 15 x 1,5	PR5		1SNA 168 700 R2200
Rail	32 x 15 x 1,5	PR1.2Z		1SNA 163 050 R0400

Other end stops, rails and accessories : see section on accessories.

Notes

Some accessories can decrease the block's voltage rating. For more information, consult us.

MS 4/6...

Spacing 6 mm + 0,05 (.238")

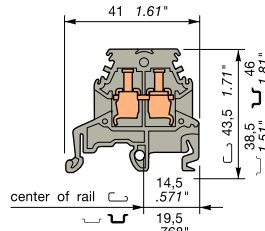

Simplified 6 mm block (compact over-all dimensions)

MS 6/8...

Spacing 8 mm - 0,05 (.315")

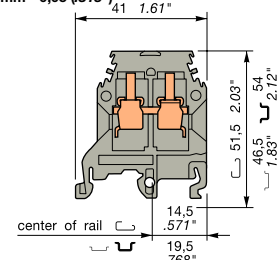

Simplified 8 mm block (compact over-all dimensions)

Colour	Type	Part numbers
Grey	MS 4/6	1SNA 115 265 R2400
Blue	MS 4/6.N	1SNA 125 265 R2600
Orange	MS 4/6	1SNA 105 013 R1200
Yellow	MS 4/6	1SNA 105 265 R0300
Beige V0	MS 4/6.V0	1SNA 195 265 R2500

Colour	Type	Part numbers
Grey	MS 6/8	1SNA 115 278 R0100
Blue	MS 6/8.N	1SNA 125 278 R0300
Orange	MS 6/8	1SNA 105 014 R1300

Characteristics				
Wire size				
		IEC	UL	CSA
		NFC DIN		
Screw clamp	Rigid	0,2-4 mm ²	22-10 AWG	22-12 AWG
	Flexible	0,22-4 mm ²	22-10 AWG	22-12 AWG

Characteristics				
Wire size				
		IEC	UL	CSA
		NFC DIN		
Screw clamp	Rigid	0,5-10 mm ²	22-8 AWG	20-8 AWG
	Flexible	0,5-6 mm ²	22-8 AWG	20-8 AWG

Voltage				
Rated		630 V	600 V	300 V
Impulse withstand		4 kV		
Pollution degree		3		
Current				
Rated		32 A	30 A	25 A
Wire size				
Rated / Gauge		4 mm ² / A4	10 AWG	12 AWG
Wire stripping length	Recommended screwdriver	Recommended torque	protection	
10 mm	4 mm	0,5-0,8 Nm	IP 20	
.39"	.157"	4.4-7.1 lb.in	NEMA 1	

Voltage				
Rated		500 V	300 V	300 V
Impulse withstand		6 kV		
Pollution degree		3		
Current				
Rated		41 A	50 A	40 A
Wire size				
Rated / Gauge		6 mm ² / A5	8 AWG	8 AWG
Wire stripping length	Recommended screwdriver	Recommended torque	protection	
12 mm	4-5 mm	0,8-1 Nm	IP 20	
.47"	.157" - .197"	7.1-8.9 lb.in	NEMA 1	

Accessories

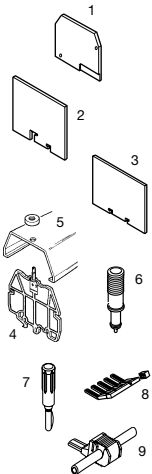

Type	P/N	
1 End section	grey blue orange yellow beige	
FEMS6	th. 3,0 mm 1SNA 113 885 R0100	
FEMS6	th. 3,0 mm 1SNA 103 292 R2500	
2 Circuit separator	grey	
SCFEX1 (1)	th. 2,4 mm 1SNA 103 619 R0400	
3 Circuit separator	grey	
SCFEX3 (1)	th. 2,4 mm 1SNA 103 620 R0100	
4 Circuit separator (for CPV cover)	grey	
SCFCV1-2 (1)	th. 3,0 mm 1SNA 116 795 R1100	
SCFCV1-2 V0(1) V0	th. 3,0 mm 1SNA 196 795 R1200	
5 Protective cover	CPV1-2 (for SCFCV1-2...)	1SNA 176 816 R1200
6 Test device	DCJ yellow	1SNA 173 059 R0300
7 Test plug	FC2 DIA. 2,0 mm	1SNA 007 865 R2600
8 Comb type jumper bar	PC6 35 A 2 poles	1SNA 113 546 R1400
	PC6 35 A 3 poles	1SNA 116 536 R0500
	PC6 35 A 4 poles	1SNA 116 537 R0600
	PC6 35 A 10 poles	1SNA 113 548 R2600
Insulating tip	EIP	1SNA 113 550 R2400
9 IDC jumper	AD2,5	1SNA 114 205 R2000

Type	P/N	
FEMS8	th. 3,0 mm 1SNA 114 195 R0600	
FEMS8	th. 3,0 mm 1SNA 103 302 R0700	
2 Circuit separator	grey	
SCFEX1 (1)	th. 2,4 mm 1SNA 103 619 R0400	
3 Circuit separator	grey	
SCFEX3 (1)	th. 2,4 mm 1SNA 103 620 R0100	
4 Circuit separator (for CPV cover)	grey	
SCFCV1-2 (1)	th. 3,0 mm 1SNA 116 795 R1100	
SCFCV1-2 V0(1) V0	th. 3,0 mm 1SNA 196 795 R1200	
5 Protective cover	CPV1-2 (for SCFCV1-2...)	1SNA 176 816 R1200
6 Test device	DCO orange	1SNA 173 060 R0000
7 Test plug	FC2 DIA. 2,0 mm	1SNA 007 865 R2600
8 Comb type jumper bar	PC8 50 A 2 poles	1SNA 116 538 R1700
	PC8 50 A 3 poles	1SNA 116 539 R1000
	PC8 50 A 4 poles	1SNA 116 540 R2500
	PC8 50 A 10 poles	1SNA 163 313 R2400
Insulating tip	EIP	1SNA 113 550 R2400
9 IDC jumper	AD2,5	1SNA 114 205 R2000

Type	P/N	
FEMS8	th. 3,0 mm 1SNA 114 195 R0600	
FEMS8	th. 3,0 mm 1SNA 103 302 R0700	
2 Circuit separator	grey	
SCFEX1 (1)	th. 2,4 mm 1SNA 103 619 R0400	
3 Circuit separator	grey	
SCFEX3 (1)	th. 2,4 mm 1SNA 103 620 R0100	
4 Circuit separator (for CPV cover)	grey	
SCFCV1-2 (1)	th. 3,0 mm 1SNA 116 795 R1100	
SCFCV1-2 V0(1) V0	th. 3,0 mm 1SNA 196 795 R1200	
5 Protective cover	CPV1-2 (for SCFCV1-2...)	1SNA 176 816 R1200
6 Test device	DCO orange	1SNA 173 060 R0000
7 Test plug	FC2 DIA. 2,0 mm	1SNA 007 865 R2600
8 Comb type jumper bar	PC8 50 A 2 poles	1SNA 116 538 R1700
	PC8 50 A 3 poles	1SNA 116 539 R1000
	PC8 50 A 4 poles	1SNA 116 540 R2500
	PC8 50 A 10 poles	1SNA 163 313 R2400
Insulating tip	EIP	1SNA 113 550 R2400
9 IDC jumper	AD2,5	1SNA 114 205 R2000

R See section on markers marking method

Top of the block RC65 Side of the block RC65 - RC810
 Note : (1) End section and circuit separators snapped on rails

Top of the block RC65 Side of the block RC810