

IP68 water resistant, enabling submerged operation

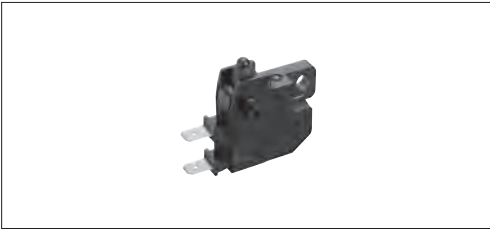

Ratings and Safety Standards

Items	Specifications
Rating (max.)	4.5A 12V DC (lamp load: 27W×2)
Rating (min.)	10mA 12V DC (Resistive load)
Contact resistance	500mΩ max.
Operating force	4.6N max.
Operating life	100,000 cycles

Product Line

Type	Circuit arrangement	Travel (mm)	Mounting method	Terminal configuration	Minimum order unit (pcs.)		Product No.
					Japan	Export	
Push	SPST (Normal Close)	3.7	Snap-in	Tab Terminal (#187)	180	360	SDDHA10100

Packing Specifications

Number of packages (pcs.)		Export package measurements (mm)
1 case /Japan	1 case /export packing	
180	360	400×270×185

Dimensions

Unit:mm

Style

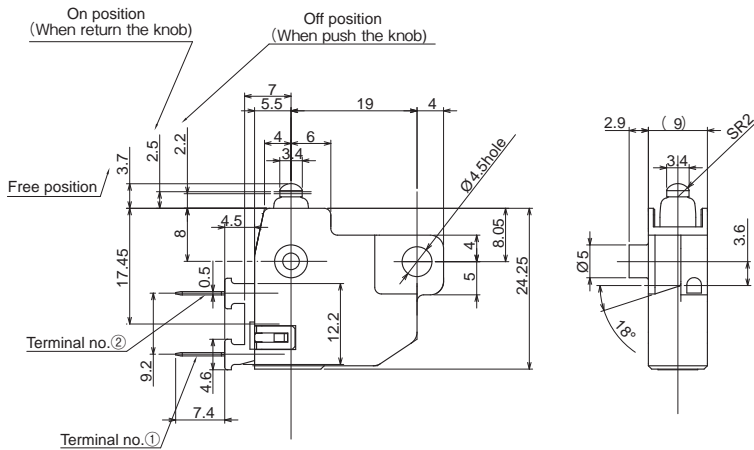
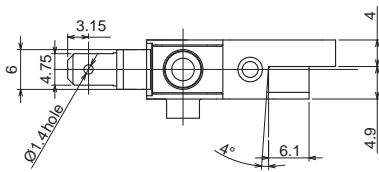



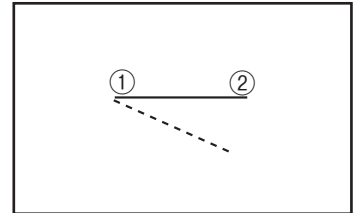





Circuit Diagram



Power Switches

List of Varieties

Type		Push		Rocker	Rotary	
Series		SDKR	SDDH	SDDJE ※ 1 ※ 2	SDDE	
Photo						
Rating		0.5A 250V AC 1A 125V AC 10mA 5V DC	Rating (max.): 4.5A 12V DC (Lamp load: 27Wx2) Rating (min.): 10mA 12V DC (Resistive load)	10AGP 250V AC 6A / 96A 250V~	AC Switch: 1A / 16A 250V ~ DC Switch: 20mA 12V DC Encoders: 0.1A 12V DC	
Operating life		100,000cycles	100,000 cycles	10,000cycles	AC Switch: 10,000 cycles DC Switch: 10,000 cycles	
		0.5A 250V AC		10A 250V AC		Encoder 30,000 cycles
Travel (mm)		1.5	3.7	3.4	Push Switches: 1.85mm Encoders: 360° (360° Rotation)	
Features		Water-proof type With signal circuit	Water-proof (IP68 rating)	—	AC Switch, DC Switch, With Encoder	
Operating temperature range		-10°C to +85°C	-15°C to +80°C	-10°C to +55°C	0°C to +85°C	
Automotive use		—	●	—	—	
Life cycle (availability)						
Electrical performance	Contact resistance	100mΩ max. (AC switch) 500mΩ max. (DC switch)	500mΩ max.	100mΩ max.	AC Switch: 100mΩ max. DC Switch: 500mΩ max. Encoder: 1Ω max.	
	Insulation resistance	500MΩ min. 500V DC (AC switch) 100MΩ min. 100V DC (DC switch)	10MΩ min. 500V DC	500MΩ min. 500V DC	AC Switch: 100MΩ min. 500V DC DC Switch: 100MΩ min. 100V DC Encoder: 100MΩ min. 100V DC	
	Voltage proof	1000V AC for 1minute (AC switch) 100V AC for 1minute (DC switch)	500V AC for 1minute	2,000V AC for 1minute	AC Switch: 2,000V AC for 1 minute DC Switch: 100V AC for 1 minute Encoder: 100V AC for 1 minute	
Mechanical performance	Terminal strength	5N for 1minute	Slider pull-out strength: 100N min.	50N for 1minute (Lead terminal) 5N for 1minute (Right-angle terminal)	AC Switch: 5N for 1 minute DC Switch: 5N for 30s Encoder: 5N for 1 minute	
	Actuator strength	Operating direction	100N	—	25N	100N
		Perpendicular direction	20N	—	25N	30N (Retract direction)
Environmental performance	Cold	-20°C 240h	-15°C 96h	-20°C 96h	-40°C 240h	
	Dry heat	85°C 240h	80°C 96h	85°C 96h	85°C 240h	
	Damp heat	60°C, 90 to 95%RH 1000h	40°C, 90 to 95%RH 96h		40°C, 90 to 95%RH 240h	
Page		148	149	150	154	

Power Switches Soldering Conditions	155
Power Switches Cautions	155
Power Switches Safety Standard	155

Notes

- ※ 1. Dip soldering can be used on SDDJE for PC board terminal and SDDJF right angle terminal types only.
- ※ 2. The operating temperature range can be raised upon request. Please contact us for details.
- Indicates applicability to all products in the series.