



DC Over Current Monitor

SPECIFICATIONS

| | | |
|---------------------------|--|-------------------------------|
| CONTROL VOLTAGE | 120 VAC, 50/60 Hz | |
| TRIP POINTS | Over Current | |
| | Pick-up | See order information |
| | Drop-out | 5% below Pick-up |
| OUTPUT | SPDT, 10 Amps @ 240 VAC Resistive | |
| HYSTERESIS | 5% | |
| RESPONSE TIME | Operate | 0.2 to 10 SEC, Adjustable |
| | Release | 0.2 SEC. |
| INDICATORS | Trip (Red) | Glows On Over Current |
| | Relay (Green) | Glows when Relay is energized |
| RESET | Automatic | |
| TEMPERATURE RATING | Operate | 32° to 131°F (0° to +55°C) |
| | Storage | -49° to 185°F (-45° to +85°C) |
| ENCLOSURE | Lexan Surface Mounted; #8-32 Screw Terminals | |
| WEIGHT | 17 oz. | |

MODEL NUMBER

| | | | | | | |
|------------------------|----------------------|-----|---|---|-----|--|
| MODEL NUMBER | CDO | 120 | A | L | E | |
| CONTROL VOLTAGE | 120 Volts | | | | | |
| TYPE OF VOLTAGE | AC | | A | | | |
| ADJUSTMENT | Lockshaft | | | L | | |
| FEATURES | 0.2 to 1 amp adj. | | | | 1 | |
| | 0.5 to 2.5 amps adj. | | | | 2.5 | |
| | 1.0 to 5.0 amps adj. | | | | 5 | |
| | 2.0 to 10 amps adj. | | | | 10 | |
| | 4.0 to 20 amps adj. | | | | 20 | |

The **CDO Series** is used to detect **OVER CURRENT** conditions. The internal relay energizes (Pick-up) when the monitored current exceeds the preset trip point for longer than the adjustable time delay. The delay is incorporated to prevent nuisance tripping caused by inrush currents. The CDO has an automatic reset feature. The internal relay de-energizes (Drop-out) when the current drops 5% below the preset trip for longer than 0.2 seconds.

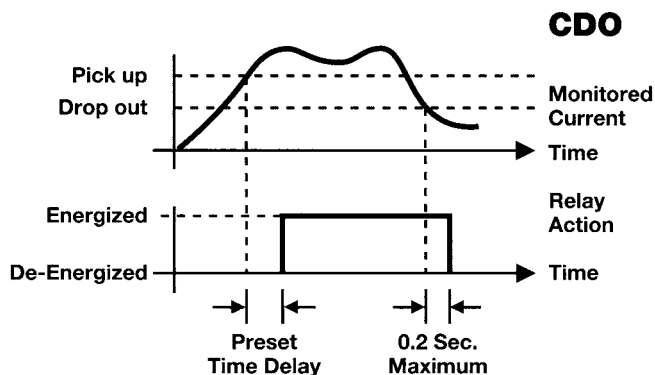

DIMENSIONS (INCHES)

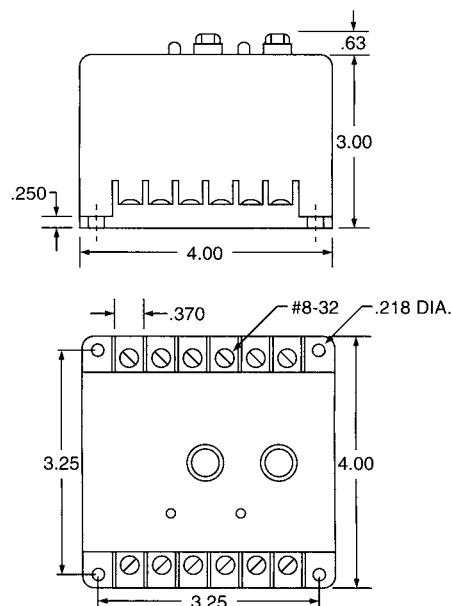

WIRING

