



DC Over Current Monitor

SPECIFICATIONS

CONTROL VOLTAGE 120 VAC, 50/60 Hz

TRIP POINTS
 Over Current
 Pick-up See order information
 Drop-out 5% below Pick-up

OUTPUT SPDT, 10 Amps @ 240 VAC Resistive

HYSTERESIS 5%

RESPONSE TIME
 Operate 0.2 to 10 SEC, Adjustable
 Release 0.2 SEC.

INDICATORS
 Trip (Red) Glows On Over Current
 Relay (Green) Glows when Relay is energized

RESET Automatic

TEMPERATURE RATING
 Operate 32° to 131°F (0° to +55°C)
 Storage -49° to 185°F (-45° to +85°C)

ENCLOSURE Lexan Surface Mounted; #8-32 Screw Terminals

WEIGHT 17 oz.

MODEL NUMBER

| | | | | | | |
|-------------------------------------|-----|-----|---|---|---|-----|
| MODEL NUMBER | CDO | 120 | A | L | E | |
| CONTROL VOLTAGE 120 Volts | | 120 | | | | |
| TYPE OF VOLTAGE AC | | | A | | | |
| ADJUSTMENT Lockshaft | | | | L | | |
| FEATURES | | | | | | |
| 0.2 to 1 amp adj. | | | | | | 1 |
| 0.5 to 2.5 amps adj. | | | | | | 2.5 |
| 1.0 to 5.0 amps adj. | | | | | | 5 |
| 2.0 to 10 amps adj. | | | | | | 10 |
| 4.0 to 20 amps adj. | | | | | | 20 |

The **CDO Series** is used to detect **OVER CURRENT** conditions. The internal relay energizes (Pick-up) when the monitored current exceeds the preset trip point for longer than the adjustable time delay. The delay is incorporated to prevent nuisance tripping caused by inrush currents. The CDO has an automatic reset feature. The internal relay de-energizes (Drop-out) when the current drops 5% below the preset trip for longer than 0.2 seconds.

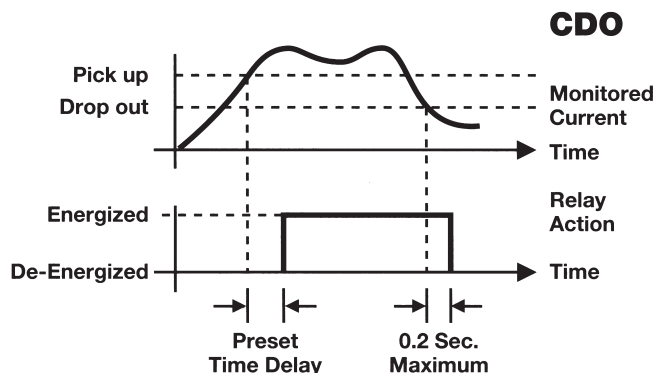

DIMENSIONS (INCHES)

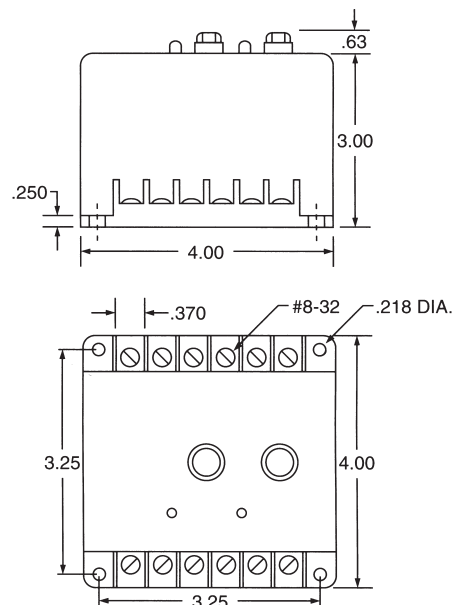

WIRING

