

24A 300V

5 and 5.08mm

24A 300V

5 and 5.08mm

**Specifications: PSQ Series****Features:**

- \*PSQ is supplied with clamp in the *open* position
- \*Double captive screws
- \*Elevator clamp style
- \*Testing holes/points
- \*2 and 3 positions single mold
- \*Up to 30 positions modular
- \*Housing is resistant to chlorinated solvents, with no dioxin or detrimental to health halogens.
- \*Positions are contacts *per row*, not *total* contacts
- \*All PSQ and MSQ blocks can be interlocked to form custom configurations
- \*Every position of this product is mechanically and electrically tested during assembly to ensure a 100% defect free product.
- \*Minimum 5 microns of tin plating on terminal for easy soldering.

**Electrical**

Current:	24A @ 300V
Wire range:	12 to 30 AWG
Wire section(mm <sup>2</sup> ):	0.05 to 4mm <sup>2</sup>
Pin dimension:	1mm x 0.8mm
CR:	<15mΩ
IR:	>10 <sup>9</sup> Ω (500V DC)
Operating temp:	-40°C to +110°C
Stripping length:	6.5mm
Torque:	0.5 Nm
PCB holes:	min 1.4mm
PCB thickness:	max 2.4mm
Climactic category:	40/110/21 Acc. to IEC 68-1

**Materials**

Housing:	Polyamide 6,6 (UL94V-0)
Clamp:	Copper alloy, Ni plated
Terminal:	Copper alloy, Tin plated
Screw:	M3, copper alloy, Ni plated
Colors available:	Green, black

**Marking**

Adhesive marking strips 5 and 5.08mm centers.

Numbered	Order Number
1-10	ESA14000110
11-20	ESA14001120
21-30	ESA14002130
31-40	ESA14003140
41-50	ESA14004150

Ink marking by factory (specify in order number):

Factory ink is permanent and will not rub off. Ink has fluorescent tint for greater visibility.

0=no printing

A=upside down printing (consecutive #'s R to L)

B=regular printing (consecutive #'s L to R)

Custom markings are welcome with minimum order. Contact factory for information.

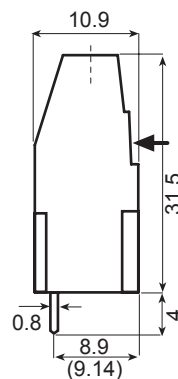
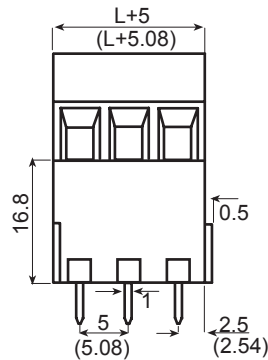
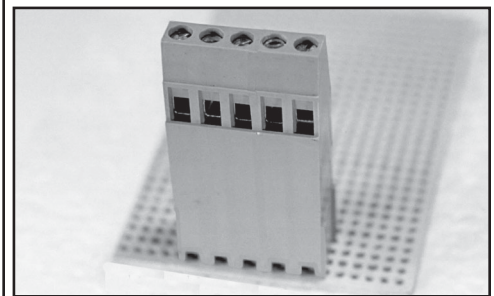
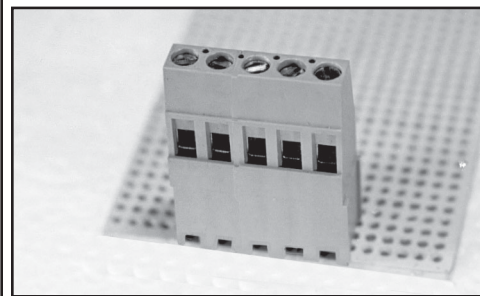
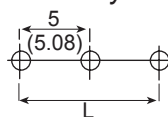
**PCB Layout****Dimensions**

n=number of poles

L=(n-1) x 5 (for 5mm spacing)

L=(n-1) x 5.08 (for 5.08mm spacing)

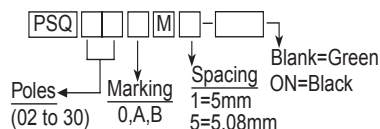
**Ordering Information**

Also available in 10mm and 10.16mm centers.

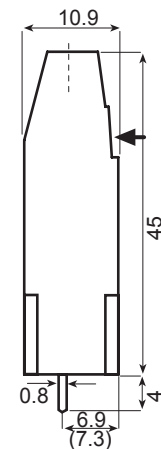
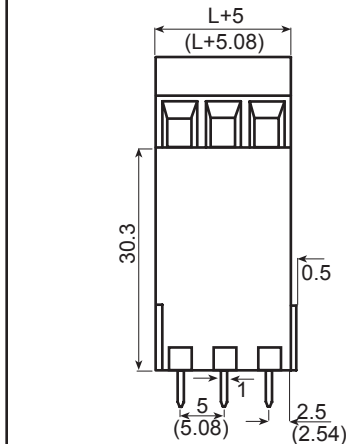
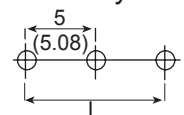
**PCB Layout****Dimensions**

n=number of poles

L=(n-1) x 5 (for 5mm spacing)

L=(n-1) x 5.08 (for 5.08mm spacing)

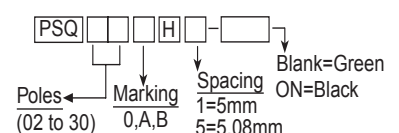
**Ordering Information**

Also available in 10mm and 10.16mm centers.

