

E222871

Miniature Toggle

Specifications

Electrical Ratings	5A @ 120VAC, 28VDC 2A @ 250VAC See Contact Options	Dielectric Strength	1500Vrms min
Electrical Life	40,000 cycles typical	Insulation Resistance	>1000MΩ min
Contact Resistance	≤10mΩ initial @ 2-4VDC, 100mA	Operating Temperature	-40°C to 85°C
		Storage Temperature	-40°C to 85°C

Materials

Actuator	Brass, Chrome Plated
Housing	Diallyl Phthalate (DAP)
Cover	Stainless Steel
Bushing	Brass, Nickel Plated
Bracket	Brass, Tin Plated
Contacts	Copper Alloy, Silver or Gold Plated
Terminals	Copper Alloy, Silver or Gold Plated

Features

- Wide variety of applications from consumer electronics to commercial
- Standard epoxy sealed terminations
- Gold contacts available for low power applications
- Available support brackets for greater stability
- Up to four poles with seven functions available
- Anti-rotation feature on flat toggles
- High torque bushing preventing separation from frame during installation
- Wide variety of terminal options

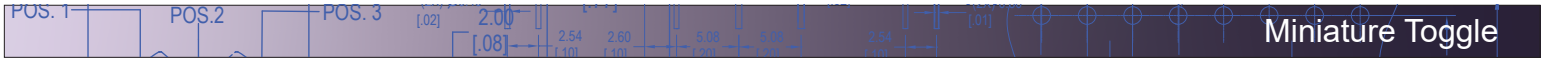

Switch Function

SPDT

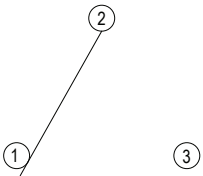
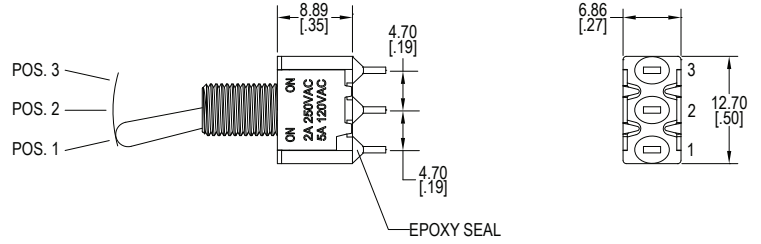
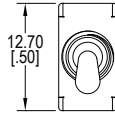

Function	Toggle Position		
1	ON	NONE	ON
2	ON	NONE	(ON)
3	ON	OFF	ON
4	(ON)	OFF	(ON)
5	ON	OFF	(ON)
Terminals	2-3	-	2-1

DPDT

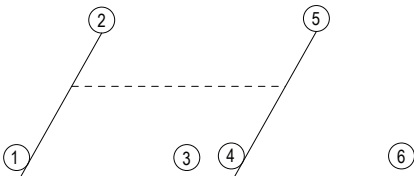
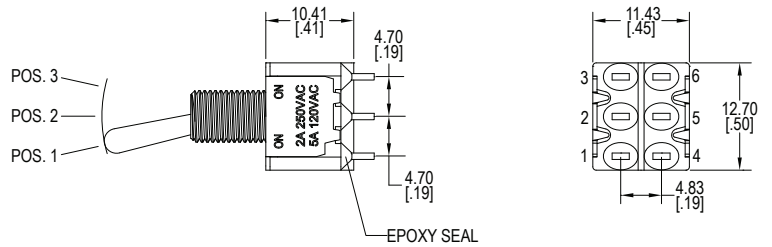
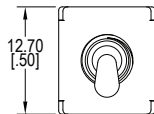
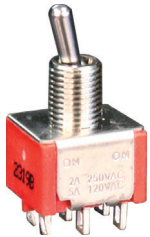

Function	Toggle Position		
1	ON	NONE	ON
2	ON	NONE	(ON)
3	ON	OFF	ON
4	(ON)	OFF	(ON)
5	ON	OFF	(ON)
Terminals	2-3	-	2-1
6	ON	ON	ON
Terminals	2-3 5-6	2-3 5-4	2-1 5-4

Switch Function

3PDT

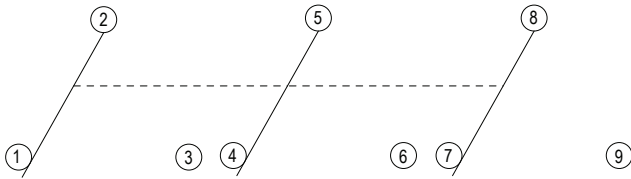
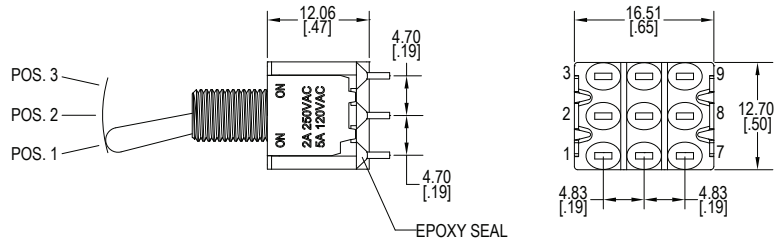
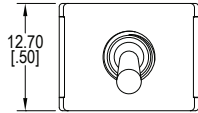

Function	Toggle Position		
1	ON	NONE	ON
2	ON	NONE	(ON)
3	ON	OFF	ON
4	(ON)	OFF	(ON)
5	ON	OFF	(ON)
Terminals	2-3 5-6 8-9	-	2-1 5-4 8-7

4PDT

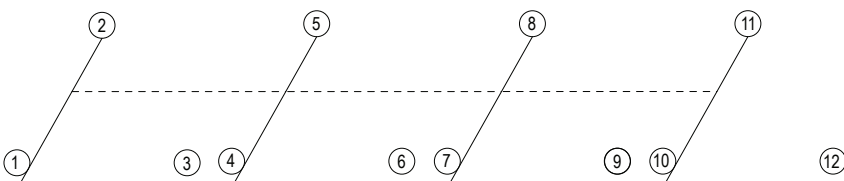
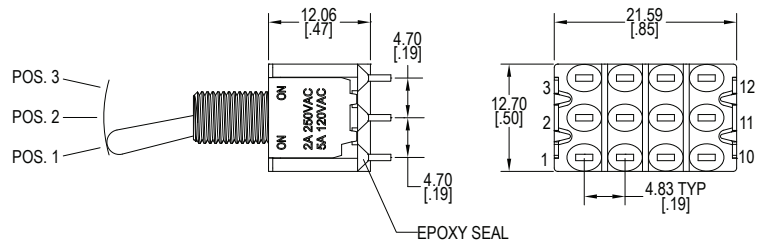
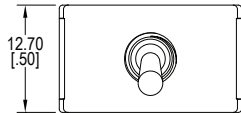

Function	Toggle Position		
1	ON	NONE	ON
2	ON	NONE	(ON)
3	ON	OFF	ON
4	(ON)	OFF	(ON)
5	ON	OFF	(ON)
Terminals	2-3 5-6 8-9 11-12	-	2-1 5-4 8-7 11-10
6	ON	ON	ON
Terminals	2-3 5-6 8-9 11-12	2-3 5-4 8-9 11-10	2-1 5-4 8-7 11-10

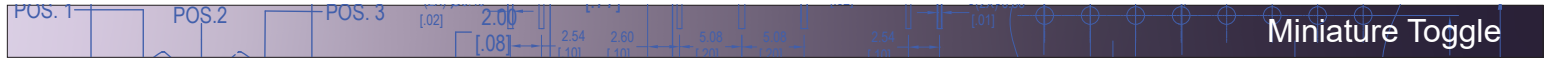

Actuator Options

Actuator lengths shown with E bushing, subtract 1.78mm for F/F1 bushing, subtract 0.51mm for M bushing

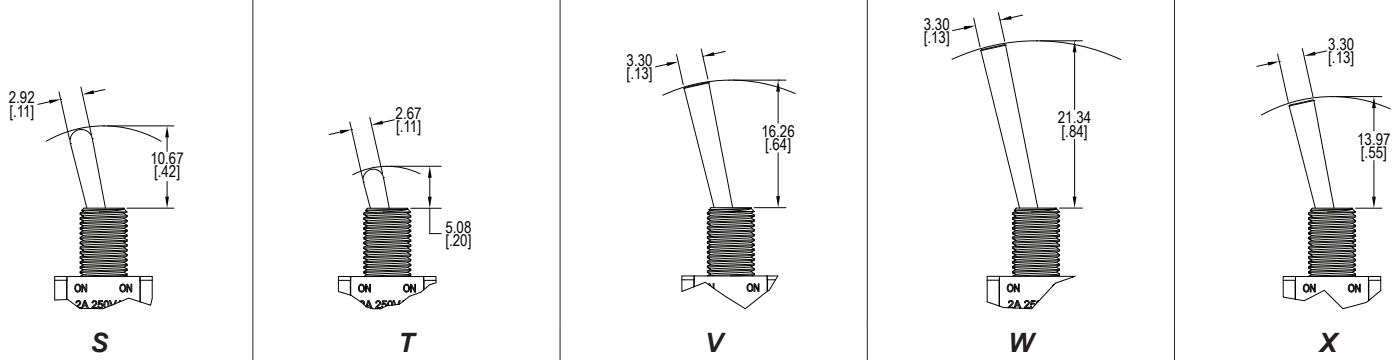

Below Actuators only available with AR1, AR2 & AN1/AN2 bushing

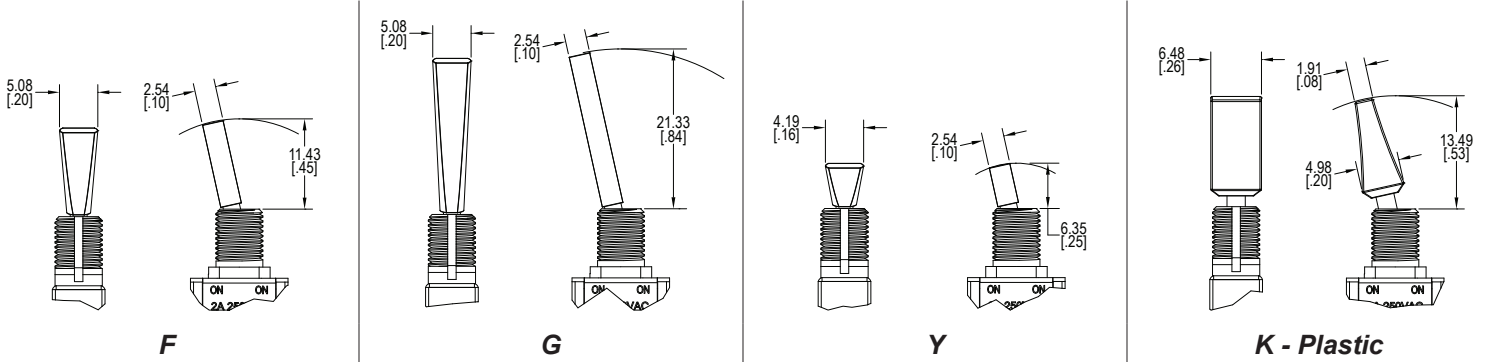

Below Actuators only available with BZ & BZR bushing

Below Actuators only available with K & K1 Bushing.
LK & LK1 are not available with momentary functions.

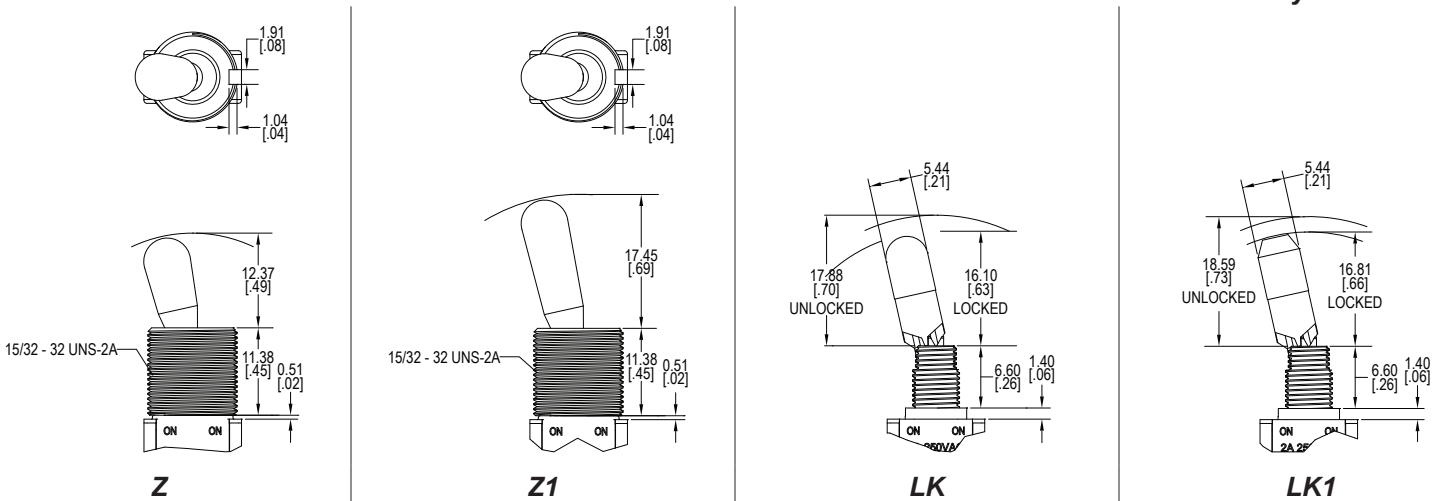

Bushing Options

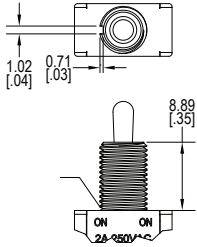

E - Threaded
E1 - Non-Treated

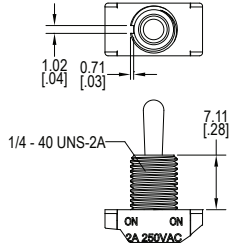

F - Threaded
F1 - Non-Treated

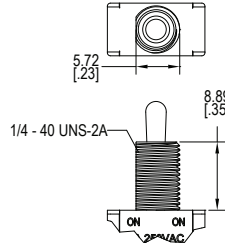

J - Threaded

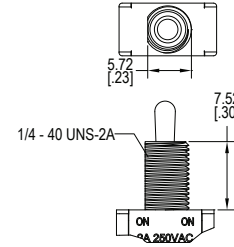

G - Threaded
High Torque

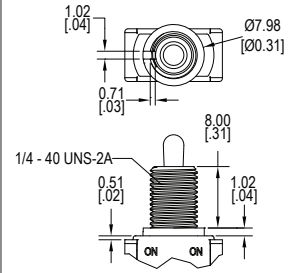

H - Threaded
High Torque

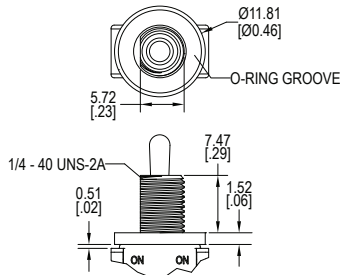

L - Threaded
Splash Proof

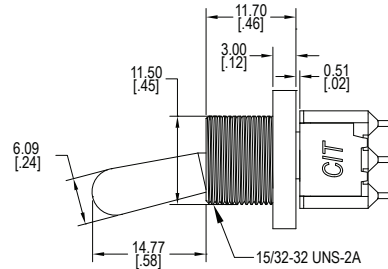
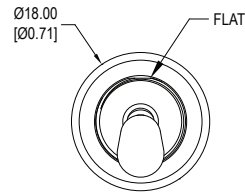

LZ - Threaded

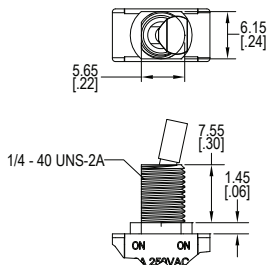
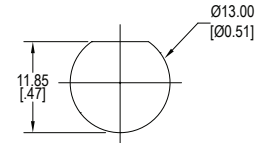

AN1 - Threaded
Anti-Rotation

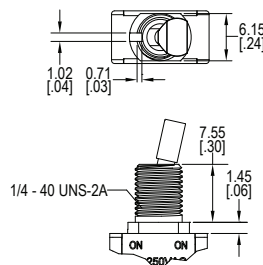

AR1 - Threaded
Anti-Rotation

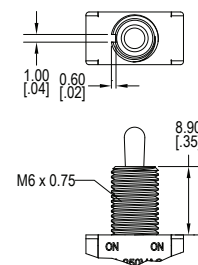

W - Threaded
Metric

Panel Cutouts

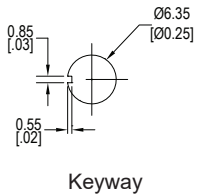

Keyway

1/4 Inch Bushing
without Locking Ring

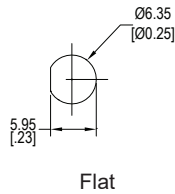

Flat

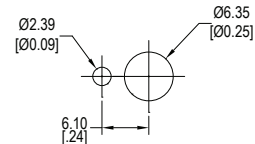

1/4 Inch Bushing
with Standard Locking Ring

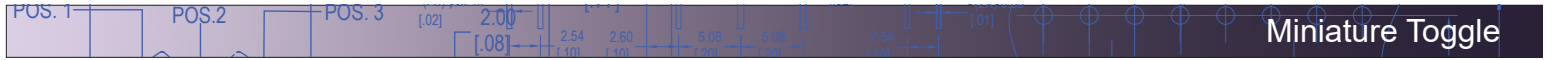

Panel Cutouts

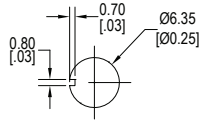

Metric Bushing without Locking Ring

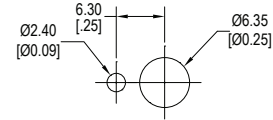

Metric Bushing with Locking Ring

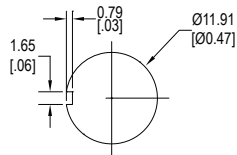

15/32 Inch Bushing without Locking Ring

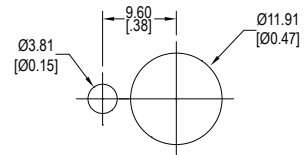

15/32 Inch Bushing with Standard Locking Ring

Terminal Options

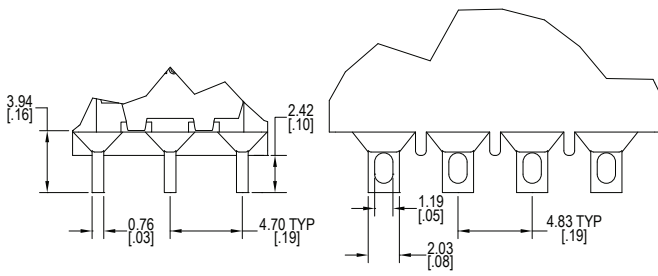

B - Solder Lug

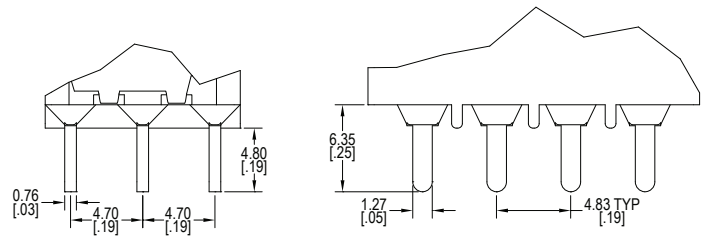

C - PC Pin

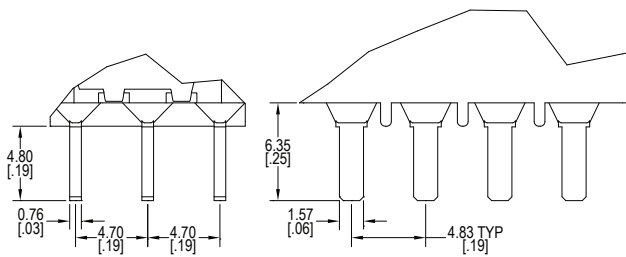

D - Quick Connect

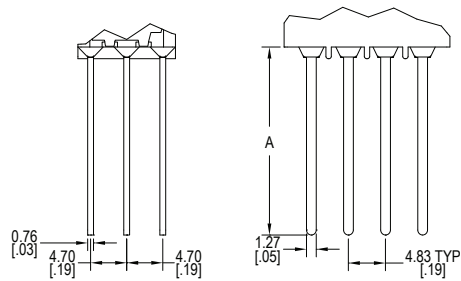

W - Wire Wrap

Terminal Length	
Option Code	"A" Dimension
W1	18.70
W2	24.20
W3	10.55
W4	26.97

Terminal Options

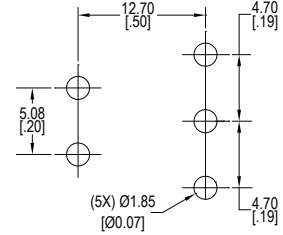
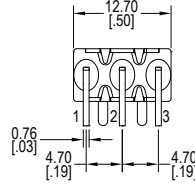
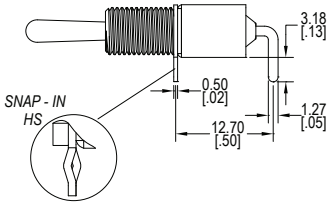
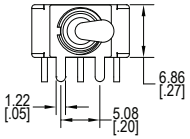

H (HS - Snap-in) = Horizontal mount, right angle PC pins, single pole

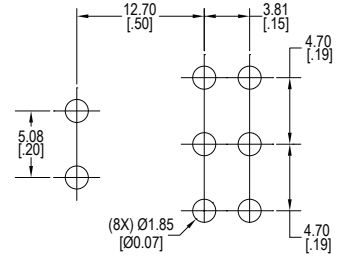
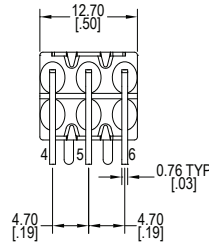
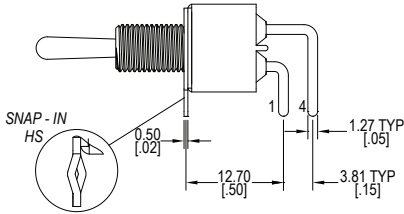
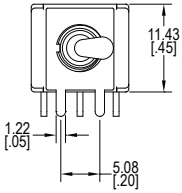

H (HS - Snap-in) = Horizontal mount, right angle PC pins, double pole

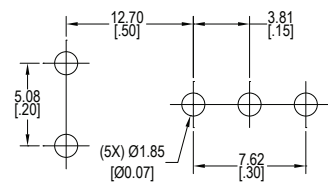
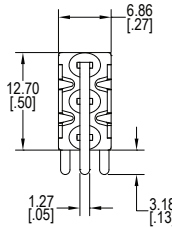
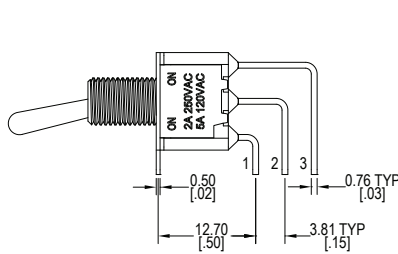
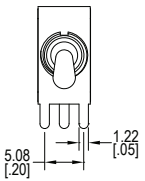

V (VS - Snap-in) = Vertical mount, right angle PC pins, single pole

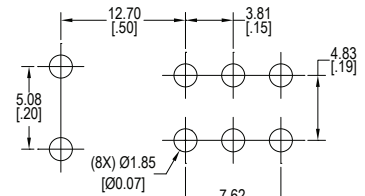
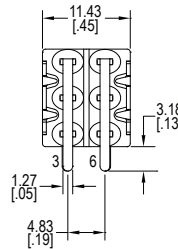
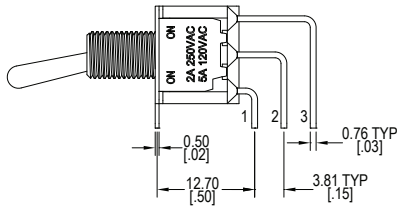
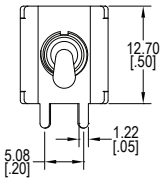

V (VS - Snap-in) = Vertical mount, right angle PC pins, double pole

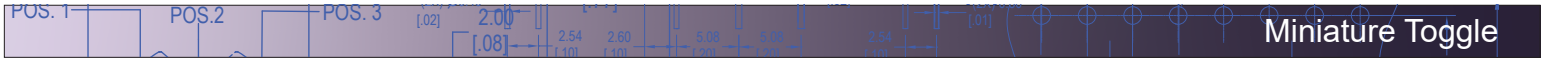

Terminal Options

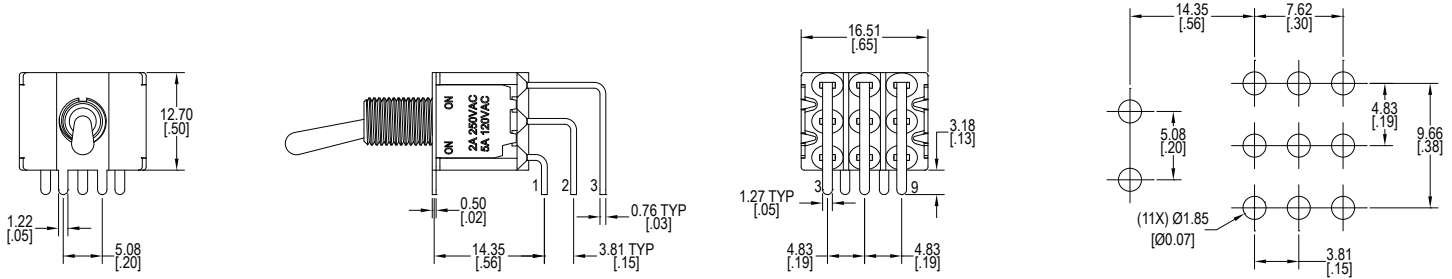

V (VS - Snap-in) = Vertical mount, right angle PC pins, three pole

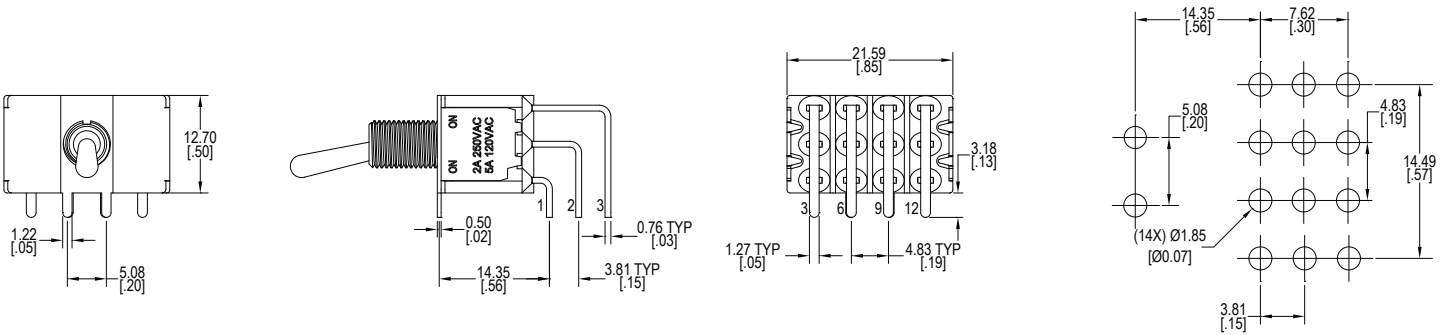

V (VS - Snap-in) = Vertical mount, right angle PC pins, four pole

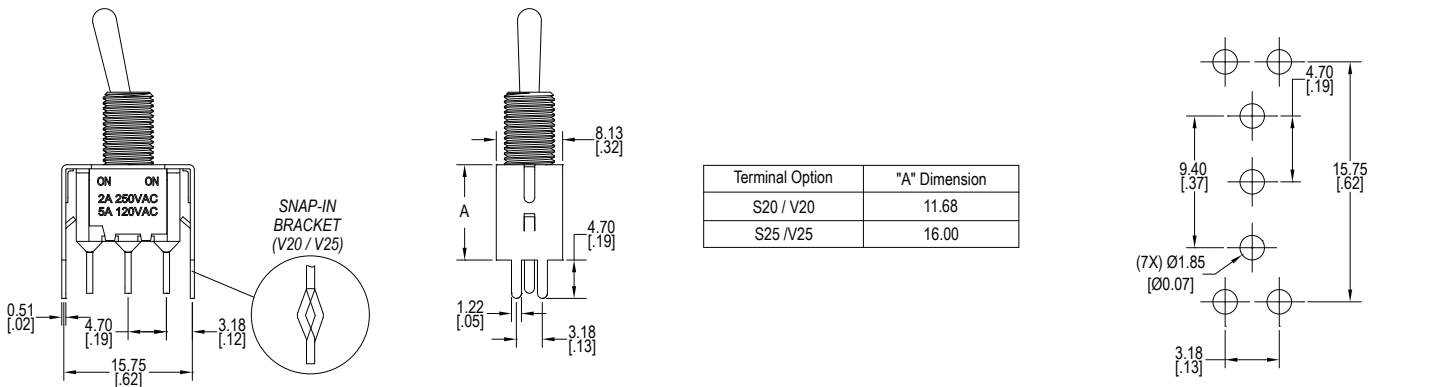

S20/S25 (V20/V25 - Snap-in) = PC pins with support bracket, single pole

Terminal Options

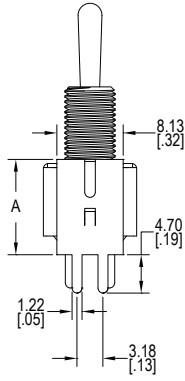
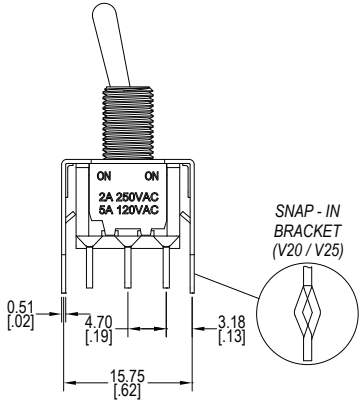

Terminal Option	"A" Dimension
S20 / V20	11.68
S20 / V25	16.00

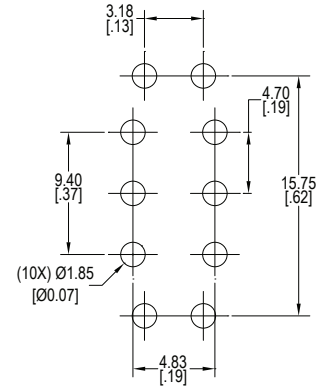

S20/S25 (V20/V25 - Snap-in) = PC pins with support bracket, double pole

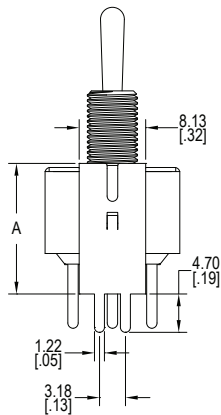
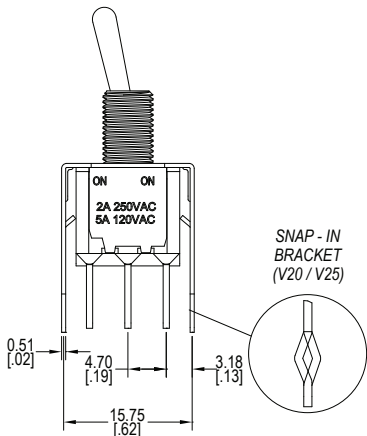

Terminal Option	"A" Dimension
S25 / V25	16.00

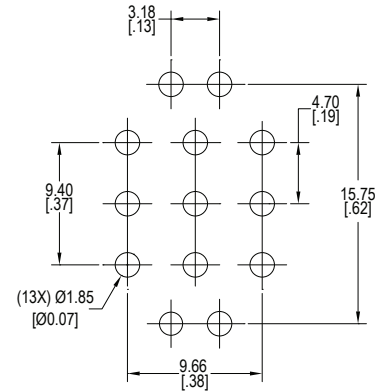

S20/S25 (V20/V25 - Snap-in) = PC pins with support bracket, three pole

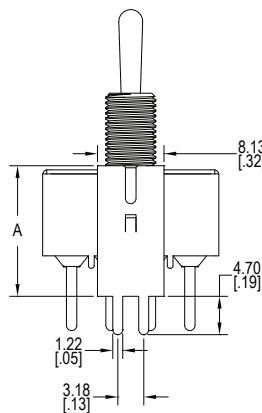
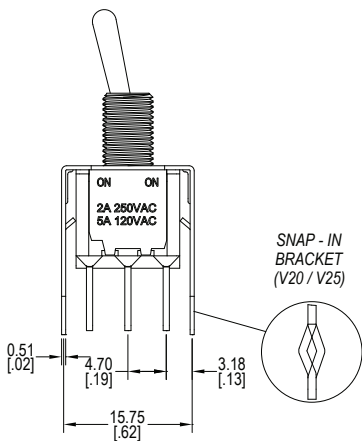

Terminal Options	"A" Dimension
S25 / V25	16.00

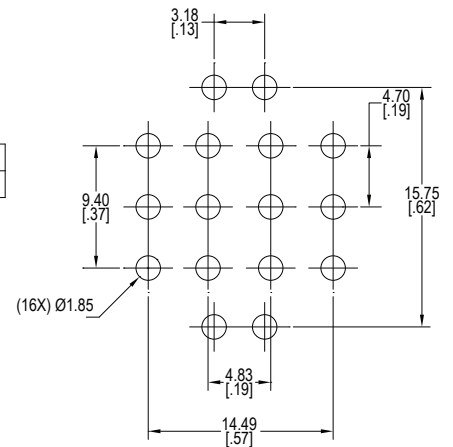

S20/S25 (V20/V25 - Snap-in) = PC pins with support bracket, four pole

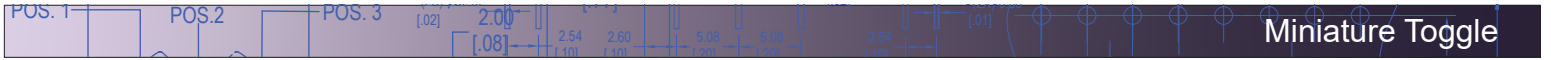

Terminal Options

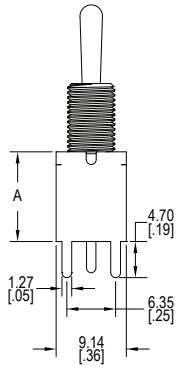
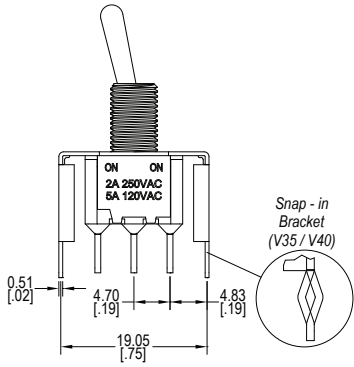

Terminal Option	"A" Dimension
S35 / V35	11.68
S40 / V40	16.00

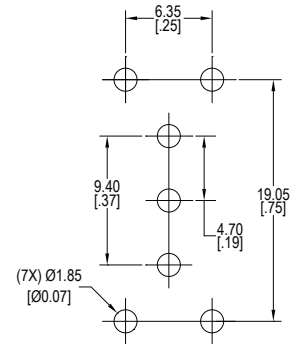

S35 (V35 - Snap-in) = PC pins with support bracket, single pole

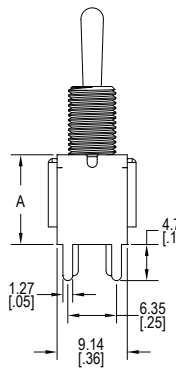
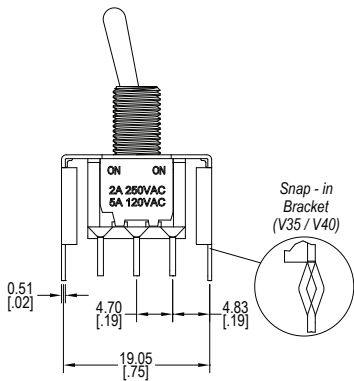

Terminal Option	"A" Dimension
S35 / V35	11.68
S40 / V40	16.00

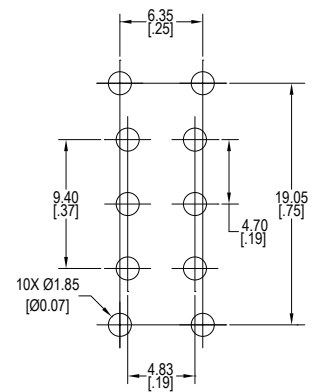

S35 (V35 - Snap-in) = PC pins with support bracket, double pole

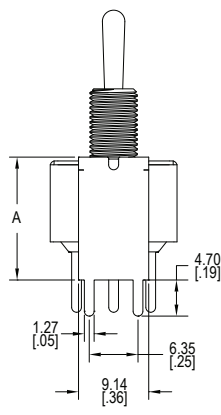
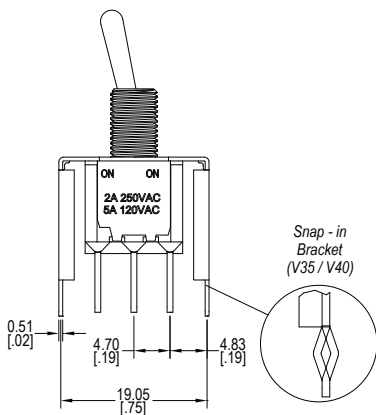

Terminal Option	"A" Dimension
S40 / V40	16.00

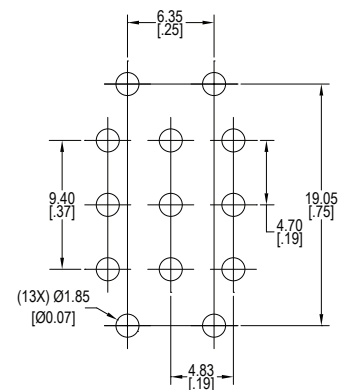

S40 (V40 - Snap-in) = PC pins with support bracket, three pole

Terminal Options

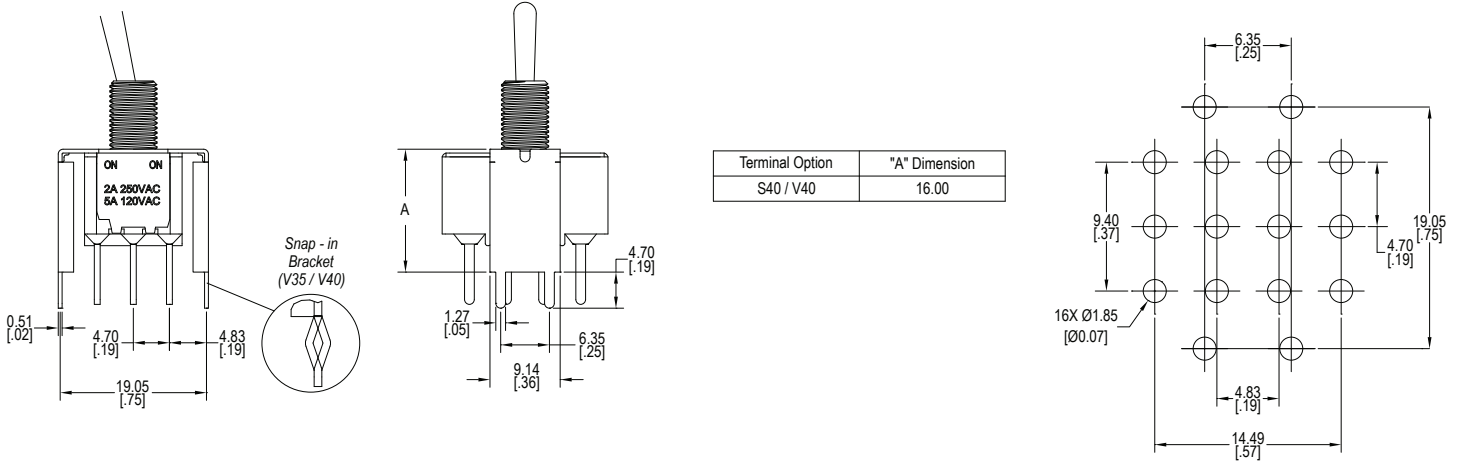

S40 (V40 - Snap-in) = PC pins with support bracket, four pole

Contact Options

Designator	Contact Material	Terminal Material	Electrical Ratings
Q	Silver Plating	Silver Plating	5A @ 120VAC, 28VDC; 2A @ 250VAC
R	Gold over Nickel Plating	Gold over Nickel Plating	0.4VA max @ 20VAC or VDC max
G	Gold over Silver Plating	Gold over Silver Plating	0.4VA max @ 20VAC or VDC max or 5A @ 120VAC, 28VDC; 2A @ 250VAC

Three Way Wiring Diagram

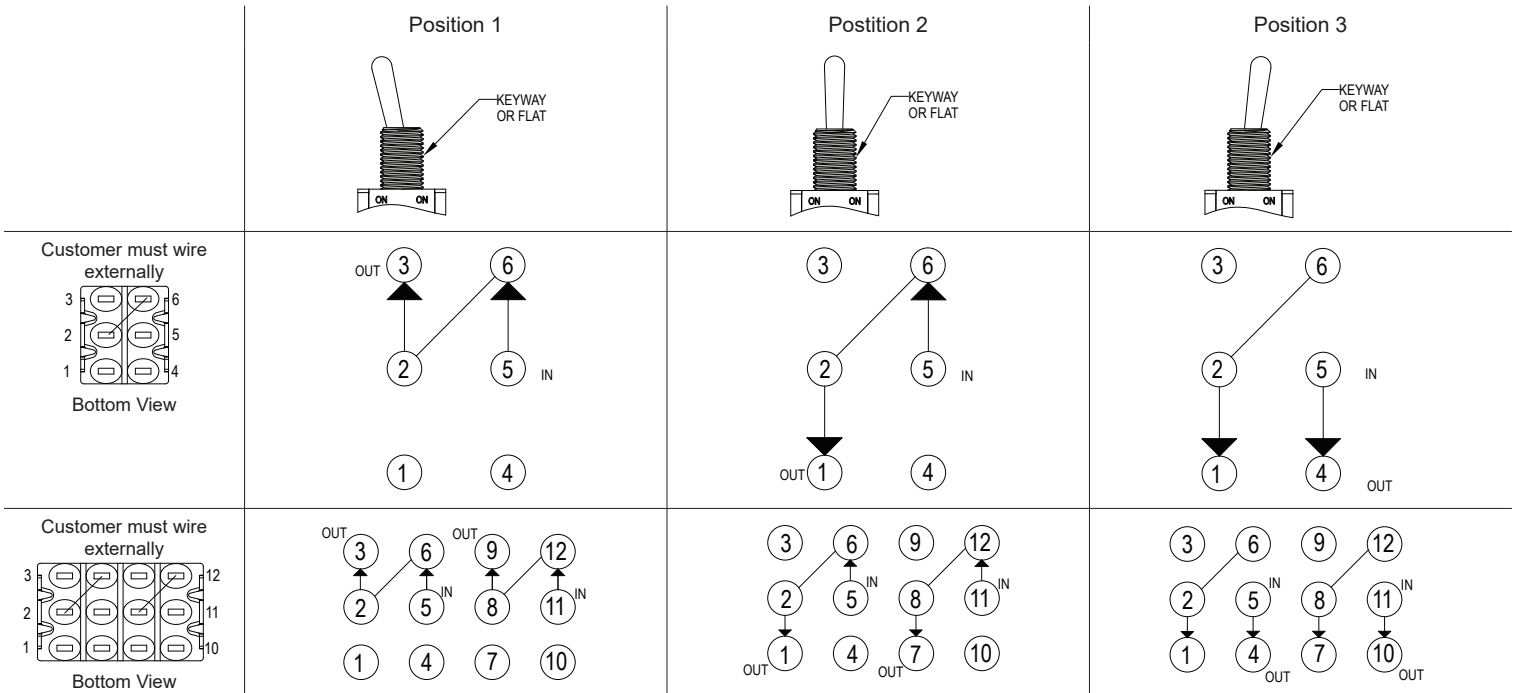

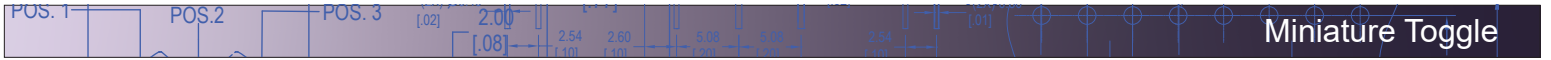

Cap Options

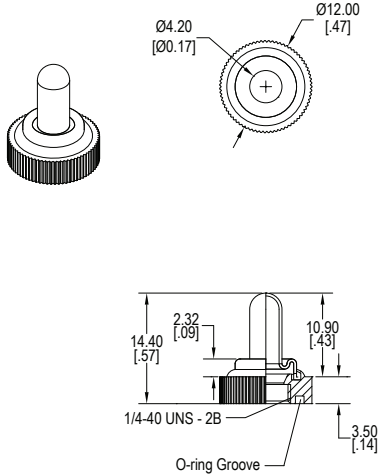

**Sealed Boot E
Knurled Nut**

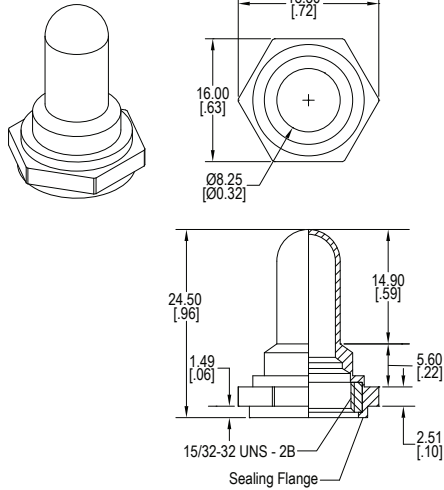

**Sealed Boot Z3
Rubber Coated**

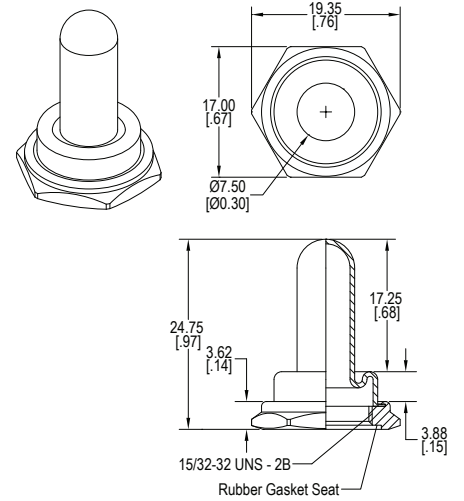

**Sealed Boot Z4
Plain Hex Nut**

Hardware

15/32 - 32 Hardware

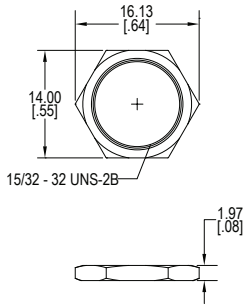

Hex Nut

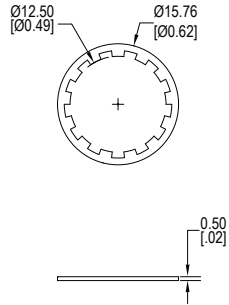

Lock Washer

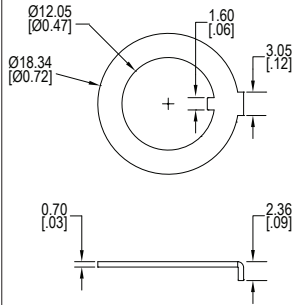

Locking Ring-Keyway

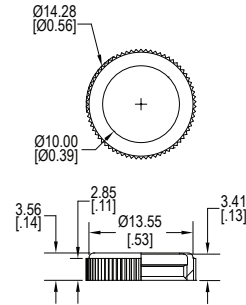

Knurled Nut

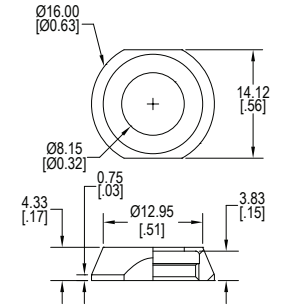

Dress Nut

Hardware

1/4 - 40 Hardware

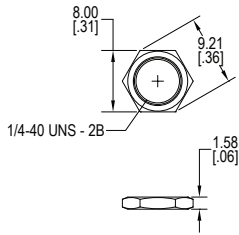

Hex Nut

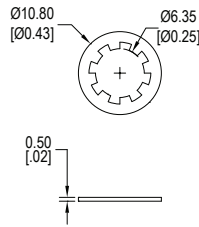

Lock Washer

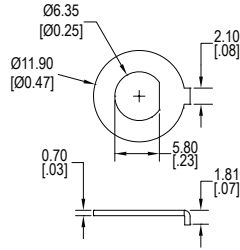

Locking Ring-Flat

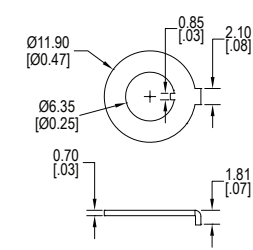

Locking Ring-Keyway

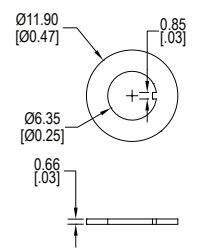

Washer-Keyway

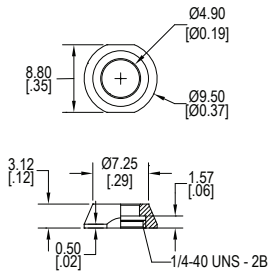

Dress Nut A

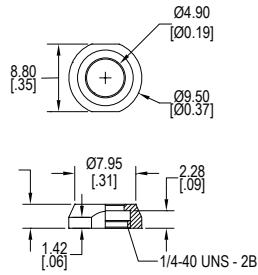

Dress Nut B

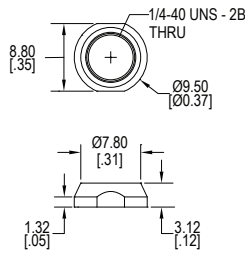

Dress Nut C

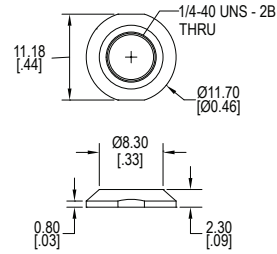

Dress Nut D

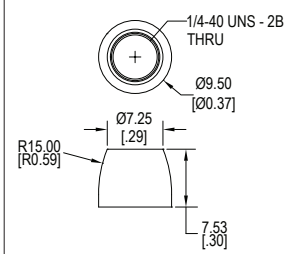

Dress Nut E

Collars

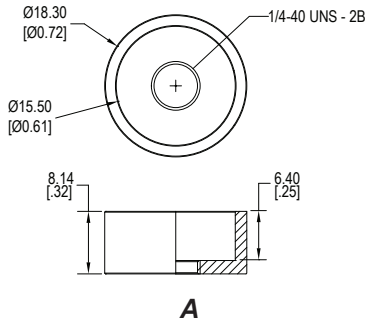

A

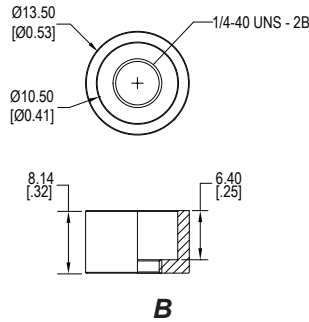

B

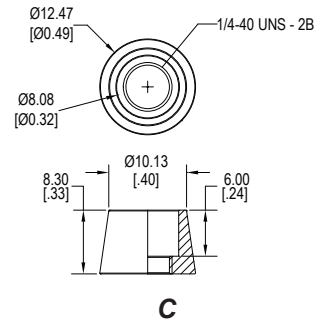

C

Knurled Nuts

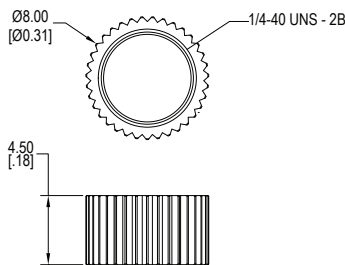
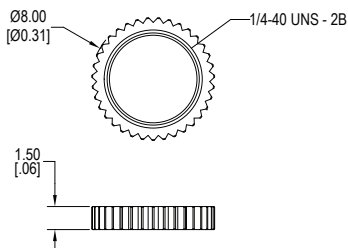

Toggle Cap "S"

