

## Specifications

Electrical Ratings	100mA @ 30VDC	Dielectric Strength	1000Vrms min
Electrical Life	100,000 cycles typical	Insulation Resistance	>100MΩ min
Contact Resistance	<50mΩ initial	Operating Temperature	-40°C to 85°C
Actuation Force	180 ± 50gF	Storage Temperature	-40°C to 85°C
Actuator Travel	1.5mm to lock 2.5mm to full travel		

## Materials

Actuator	Acetal
Housing	PBT
Cover	Acetal
Latching Pin	Stainless Steel
Spring	Stainless Steel
Contacts	Phosphor Bronze, Silver Plated
Terminals	Brass, Silver Plated

## Ordering Information

1. Series	LP2203	F180	N	Z	A																												
LP2203																																	
2. Actuation Force	F180 = F180gF																																
3. Latching	N = Non-Latching * Contact Factory for Latching Option																																
4. Actuation Options	X = 2mm x 3mm head Y = 3.3mm square head Z = 2.8mm square head																																
5. Termination	A = PC Pins, straight E = PC Pins with bend																																
6. Cap Options	<table border="0"> <tr> <td>Blank = No Cap</td> <td>C13</td> <td>Cap Colors:</td> <td></td> </tr> <tr> <td>C01</td> <td>C15</td> <td>** See Cap Options for color availability</td> <td></td> </tr> <tr> <td>C02</td> <td>C16</td> <td>** Caps available with Y &amp; Z actuators only</td> <td></td> </tr> <tr> <td>C03</td> <td>C18</td> <td></td> <td></td> </tr> <tr> <td>C04</td> <td>C19</td> <td></td> <td></td> </tr> <tr> <td>C05</td> <td>C22</td> <td></td> <td></td> </tr> <tr> <td>C12</td> <td>C26</td> <td></td> <td></td> </tr> </table>					Blank = No Cap	C13	Cap Colors:		C01	C15	** See Cap Options for color availability		C02	C16	** Caps available with Y & Z actuators only		C03	C18			C04	C19			C05	C22			C12	C26		
Blank = No Cap	C13	Cap Colors:																															
C01	C15	** See Cap Options for color availability																															
C02	C16	** Caps available with Y & Z actuators only																															
C03	C18																																
C04	C19																																
C05	C22																																
C12	C26																																

# CIT

Relay & Switch

## LP2203

### Miniature Pushbutton

### Dimensions

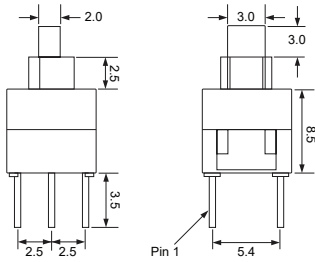
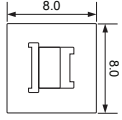

**X**

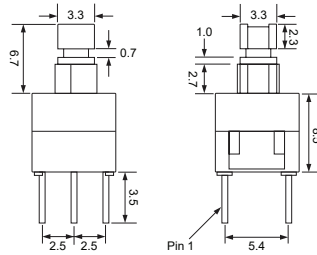
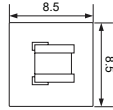

**Y**

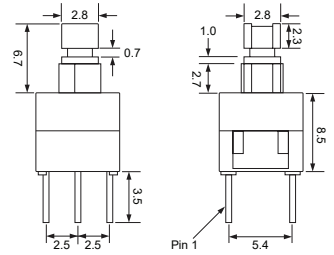
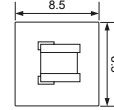

**Z**

### Schematic & PC Layout

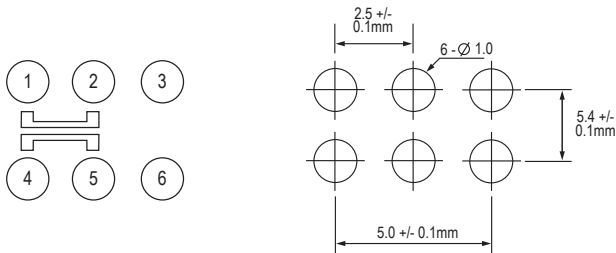

### Termination

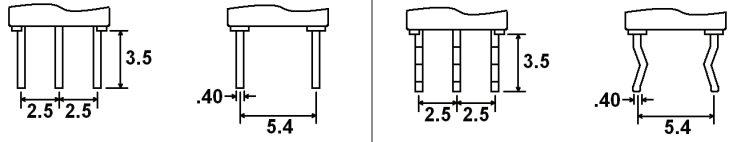

**A**

**E**

### Cap Options for Z Actuator

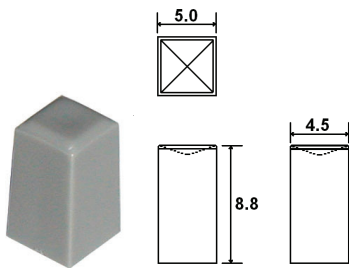

**C01\_**

1 = White, 2 = Black, 3 = Red, 9 = Light Gray  
Contact Factory for other available colors

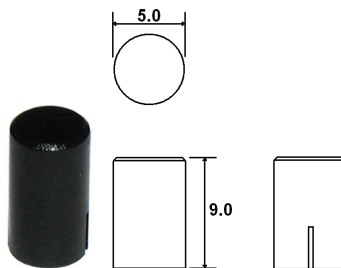

**C02\_**

1 = White, 2 = Black, 3 = Red, 9 = Light Gray  
Contact Factory for other available colors

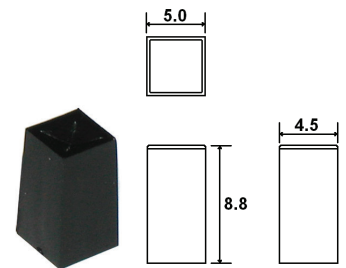

**C03\_**

1 = White, 2 = Black, 3 = Red, 9 = Light Gray  
Contact Factory for other available colors

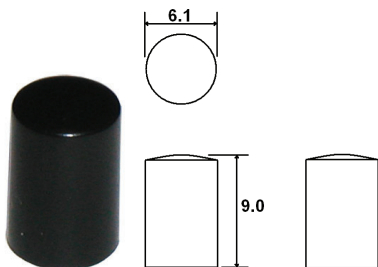

**C04\_**

1 = White, 2 = Black, 3 = Red, 9 = Light Gray  
Contact Factory for other available colors

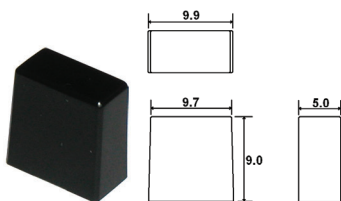

**C05\_**

1 = White, 2 = Black, 3 = Red, 9 = Light Gray  
Contact Factory for other available colors

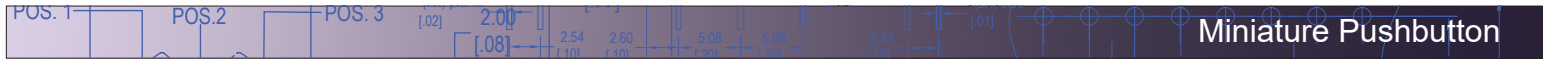

**Cap Options for Y Actuator**

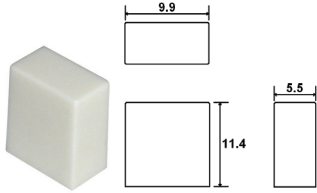

**C11\_**

1 = White, 2 = Black, 3 = Red, 9 = Light Gray  
Contact Factory for other available colors

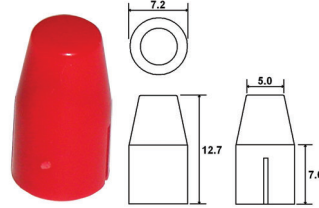

**C12\_**

1 = White, 2 = Black, 3 = Red, 9 = Light Gray  
Contact Factory for other available colors

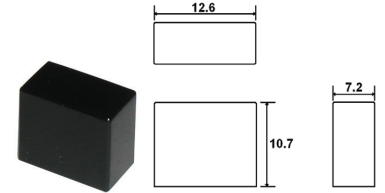

**C13\_**

1 = White, 2 = Black, 3 = Red, 9 = Light Gray  
Contact Factory for other available colors

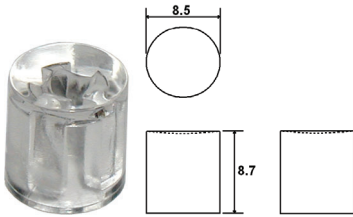

**C15\_**

2 = Black, 0 = Clear  
Contact Factory for other available colors

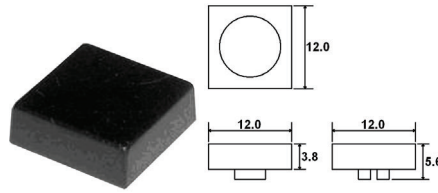

**C16\_**

1 = White, 2 = Black, 3 = Red, 7 = Blue  
Contact Factory for other available colors

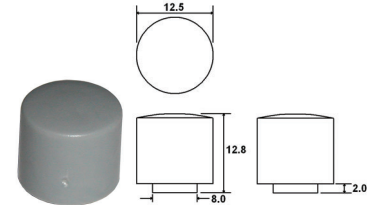

**C18\_**

1 = White, 2 = Black, 9 = Light Gray  
Contact Factory for other available colors

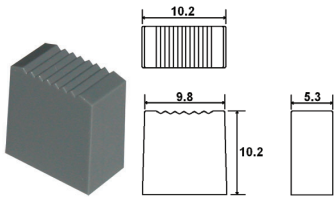

**C19\_**

1 = White, 2 = Black, 3 = Red, 8 = Dark Gray  
Contact Factory for other available colors

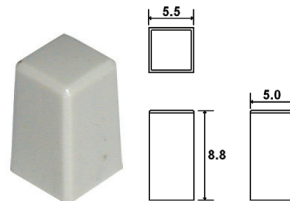

**C22\_**

2 = Black, 8 = Dark Gray, 9 = Light Gray  
Contact Factory for other available colors

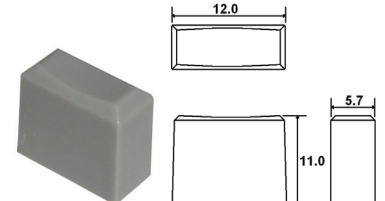

**C26\_**

1 = White, 2 = Black, 3 = Red, 9 = Light Gray  
Contact Factory for other available colors