

Proximity Switch - Reed Switch based - Rectangular - Normally Closed Contacts
Part Number : LMSB 130/30 **Suggested Magnet: LMSM**
Product Data Sheet

PICTURE

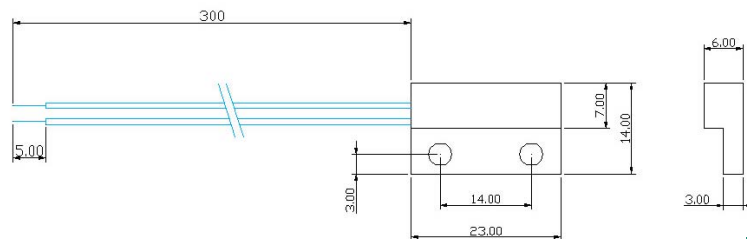

DIMENSIONS



Drawings not to scale
 All dimensions in mm nominal

✓ RoHS Compliant

SPECIFICATION

Contact Form / Style	Normally Closed
Switching Voltage	100 Vac
Switching Current	0.5 A
Switching Capacity (Resistive)	5 VA
Switching Distance	5.0 mm Minimum
Operating Temperature - Continuous	-20°C +70°C
Operating Temperature - Intermittent	-25°C +70°C
Storage temperature	-25°C +70°C
Case Material	ABS
Cable	White 7/0.2mm ² PVC 70°C

Applications Include

- Position and limit sensing.
- Linear actuators.
- Security system switch.
- Door Switch.

Options

- Higher Specification switch available. (MPSB 130/30).
- Cable Entry: Standard = Right hand entry (shown above). Also available Left hand entry.
- Custom cable lengths, strip lengths, cable types, terminations.
- If you do not see what you need, just ask, as there is a strong possibility we can do it !

Did you know we also sell?

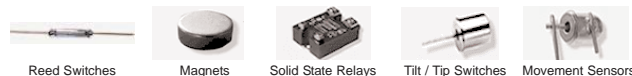

Rev. No.	Revision Note	Date	Signature
2	Datasheet Redesign	17-05-06	NG

FORM AE043 ISS.2



As part of the company policy of continued product improvement, specifications may change without notice. Our sales office will be pleased to help you with the latest information on this product range and the details of our full design and manufacturing service. All products are supplied to our standard conditions of sale unless otherwise agreed in writing.

Phone : +44 (0)1255 862236

www.assemtech.co.uk

Fax: +44 (0)1255 862014

©2006 Copyright Assemtech Europe Ltd, Unit 7, Rice Bridge Industrial Estate, Thorpe - Le - Soken, Essex, CO16 0HL, ENGLAND.