

# PLUGGABLE SOCKET

## 0.325" SPACING FOR 5000 AND TB5 SERIES

### TECHNICAL DATA

#### MECHANICAL

**Operating Temperature:**

-40°C to +105°C

-40°F to +221°F

**Soldering Temperature:**

260°C, 500°F for 5 seconds max

#### MATERIAL

**Contact:**

PhBz, Tin Plated

**Insulator Body:**

Polyamide, UL 94V-0, Black

#### ELECTRICAL

**Voltage Rating:**

300VAC

**Current Rating:**

15 Amps

### DIMENSIONAL REFERENCE

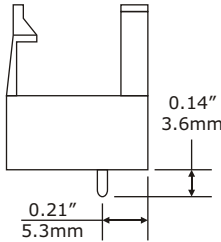
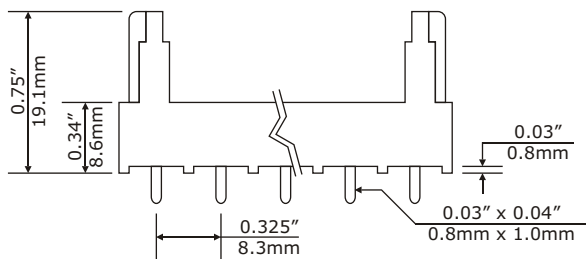
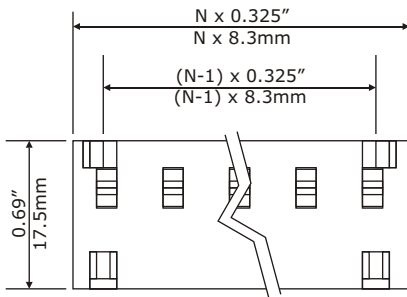
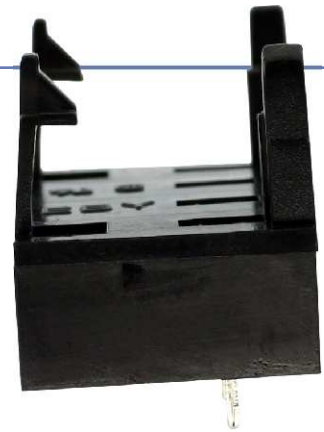

Safety Approval:



### PART NUMBERING

Part Number / Ordering Information

**SK5000-XX**

NUMBER OF  
POSITIONS  
14 Maximum

For Socket with Pre-Installed Terminal Block  
(Series 5000 or TB5)  
Consult the Factory

N = Number of contacts

**EBY Electro, Inc.**

210 Express Street  
Plainview, NY 11803-2423 USA

© Copyright 2003 EBY Electro, Inc.



Electro-Mechanical Components Since 1945

[www.ebyelectro.com](http://www.ebyelectro.com)

Email: [info@ebyelectro.com](mailto:info@ebyelectro.com)

Tel: 516.576.7777 · Fax: 516.576.1414

# PLUGGABLE SOCKET

## 0.325" SPACING FOR 5000 AND TB5 SERIES

### TECHNICAL DATA

#### MECHANICAL

**Operating Temperature:**

-40°C to +105°C

-40°F to +221°F

**Soldering Temperature:**

260°C, 500°F for 5 seconds max

#### MATERIAL

**Contact:**

PhBz, Tin Plated

**Insulator Body:**

Polyamide, UL 94V-0, Black

#### ELECTRICAL

**Voltage Rating:**

300VAC

**Current Rating:**

15 Amps

### DIMENSIONAL REFERENCE

Socket with 5000 Block

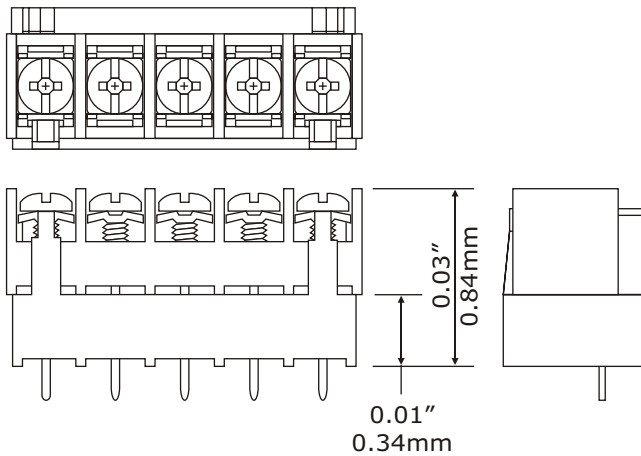

Socket with TB5 Block

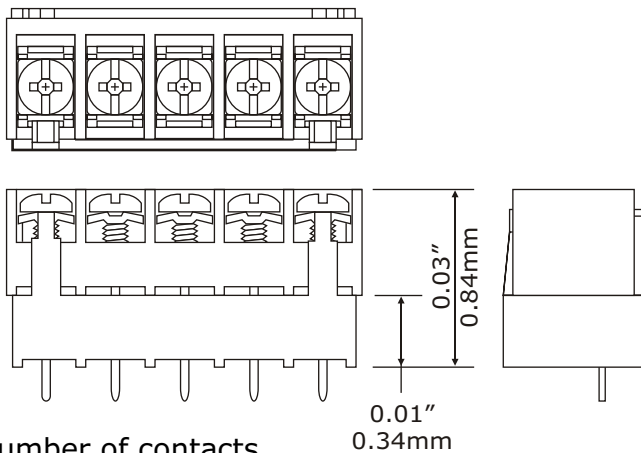

N = Number of contacts



Safety Approval:



### PART NUMBERING

Part Number / Ordering Information

**SK5000-XX**

NUMBER OF  
POSITIONS  
14 Maximum

For Socket with Pre-Installed Terminal Block  
(Series 5000 or TB5)  
Consult the Factory