

8	7	6	5	4	3	2	1
---	---	---	---	---	---	---	---

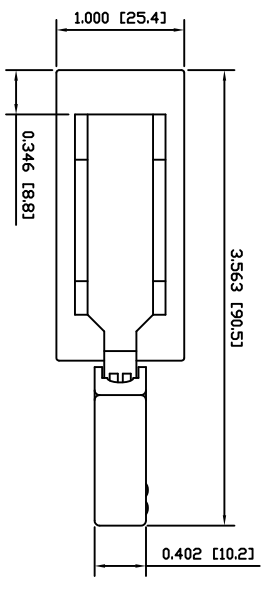

COLORS
 BODY: Black
 ACTUATOR: Black
 LOCK: None

SPECIFICATIONS
 FUNCTION: 2P1T OFF-(ON)
 RATINGS:
 24A 125VAC
 12A 250VAC
 2HP 125/250VAC
 OPERATING FORCE: 2.0kgf±0.5kgf at Highest Point
 ELECTRICAL LIFE: 50,000 Cycles
 TEMPERATURE: Operating: 0°C to 55°C
 APPROVALS:
RoHS
 COMPLIANT

MATERIALS
 LOWER BODY: Phenolic (FR), UL94 V-0
 UPPER BODY: Polyamide 6/6 (PA66), UL94 V-0
 ACTUATOR: Polyamide 6/6 (PA66), UL94 V-0
 ACTUATOR RIVET: Copper
 ACTUATOR LINK: Polyamide 6/6 (PA66), UL94 V-0
 PLATE: Polyamide 6/6 (PA66), UL94 V-0
 SEAL: Nitrile Butadiene Rubber (NBR), UL94 V-0
 CONTACT HOLDER: Polyamide 6/6 (PA66), UL94 V-0
 MAIN SPRING: Steel
 SLIDERS: Steel
 MOBILE CONTACTS: Silver Plated Brass
 CONTACT SPRINGS: Steel
 CONTACTS: Silver Alloy Clad Copper
 TERMINALS: Silver Polished Brass
 TERMINAL SCREWS: Steel
 TERMINAL HARDWARE: Steel
 GREASE: Silicone Based Grease

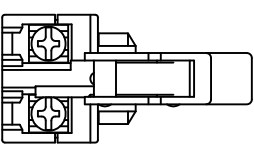
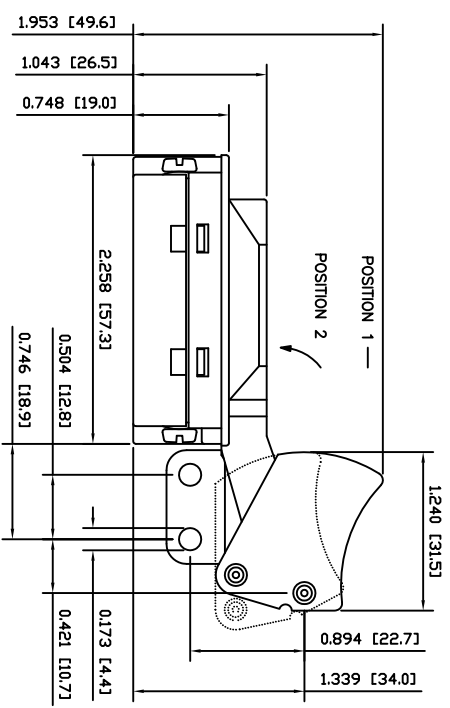

SCHEMATIC

POSITION 1 (MAINTAINED)

POSITION 2 (MOMENTARY)

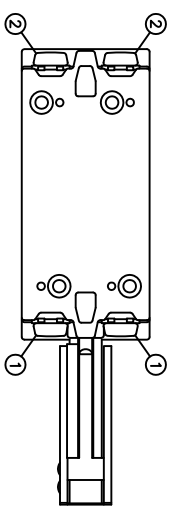

E SWITCH

LAMB INDUSTRIES

HY38-6E8-021-000

THE INFORMATION CONTAINED IN THIS DOCUMENT IS PROPRIETARY TO E-SWITCH AND IS NOT TO BE COPIED OR TRANSMITTED	REV. A	INITIAL DESCRIPTION	21298 FOR	11/26/13 DATE	EPB DRAWN BY	SCALE DRAWING NOT TO SCALE	ITEM NUMBER 34-HY386E8021000	DATE NOVEMBER 8, 2013	REVISION A
--	--------	---------------------	-----------	---------------	--------------	----------------------------	------------------------------	-----------------------	------------

8	7	6	5	4	3	2	1
---	---	---	---	---	---	---	---