

EG1315 SERIES SLIDE SWITCH

ANTI-VANDAL SWITCHES
DETECTOR SWITCHES
DIP SWITCHES
KEYLOCK SWITCHES
NAVIGATION SWITCHES
PUSHBUTTON SWITCHES
ROCKER SWITCHES
ROTARY SWITCHES
SLIDE SWITCHES
SNAP ACTION SWITCHES
TACTILE SWITCHES
TOGGLE SWITCHES
CAP OPTIONS

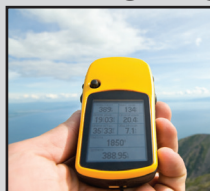

APPLICATIONS / MARKETS



Handheld Devices



Wearable Electronics



Internet of Things



Smart Home



Telecommunication

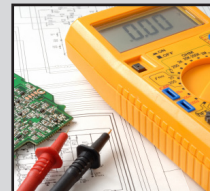

Testing Equipment

RoHS

SPECIFICATIONS

Contact Rating: 25mA @ 24VDC
Electrical Life: 10,000 Cycles
Contact Resistance: 70mΩ Max
Insulation Resistance: 1MΩ Min @ 100VDC
Dielectric Strength: 100VAC for 1 Minute
Operating Temperature: -20°C to 70°C
Storage Temperature: -40°C to 85°C
Travel: 1.50mm
Contact Arrangement: SP3T
Actuation Force: POS.2 to POS.1 or POS.3 = 200±150gF
 POS.3 or POS.1 to POS.2 = 150±100gF

FEATURES & BENEFITS

- Surface mount PC board design
- 1.50mm travel
- Compact design
- 150-200 gram force
- SP3T function

PART NUMBER CONFIGURATOR

Series



EG1315

Actuator
Option



A - 1.30mm

Function
Option



A - SP3T

Specifications subject to change without notice 7.13.2018



E-SWITCH®

www.e-switch.com

800.867.2717

1

EG1315 SERIES SLIDE SWITCH

BODY DIMENSIONS

| FUNCTION | POS. 1 | POS. 2 | POS. 3 |
|------------------|--------|--------|--------|
| A - SP3T | ON | ON | ON |
| TERMINAL CLOSURE | 1-3 | 2-3 | 3-4 |

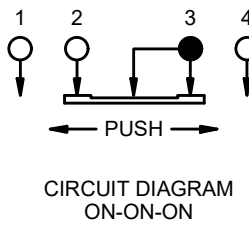

SCHEMATIC

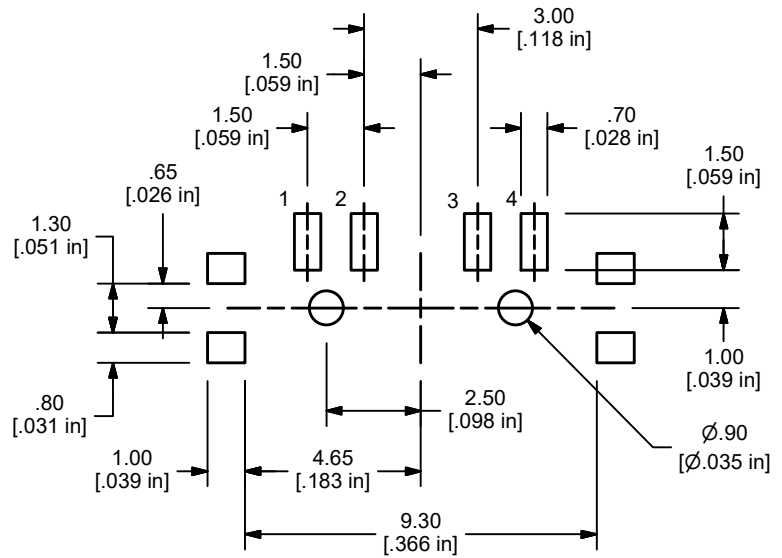

SURFACE MOUNT PCB LAYOUT

A - SP3T - FUNCTION OPTION

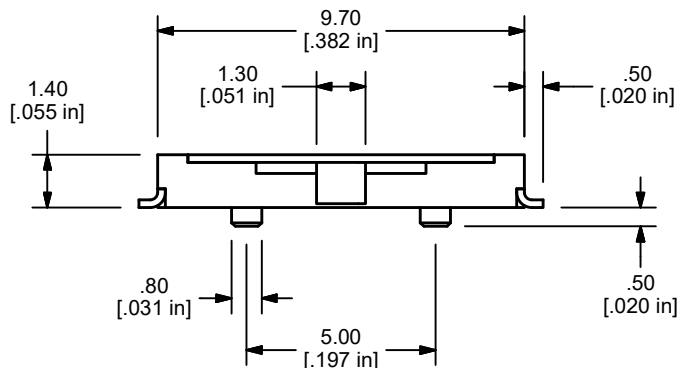
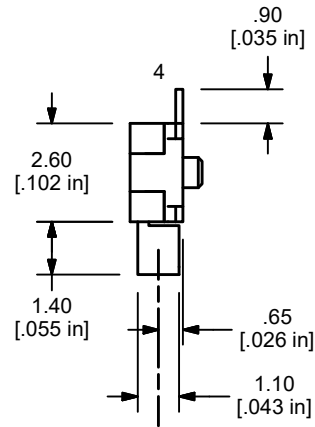
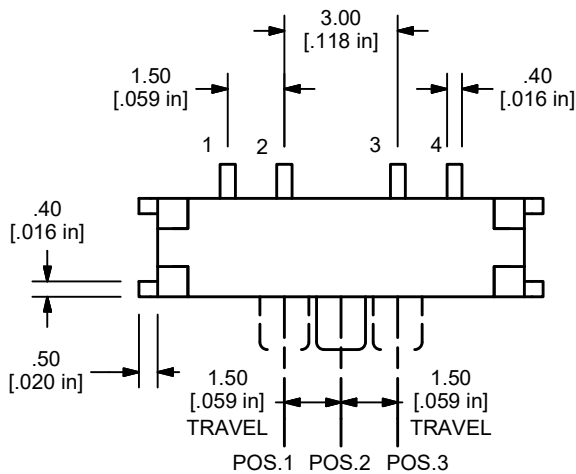

ANTI-VANDAL SWITCHES
DETECTOR SWITCHES
DIP SWITCHES
KEYLOCK SWITCHES
NAVIGATION SWITCHES
PUSHBUTTON SWITCHES
ROCKER SWITCHES
ROTARY SWITCHES
SLIDE SWITCHES
SNAP ACTION SWITCHES
TACTILE SWITCHES
TOGGLE SWITCHES
CAP OPTIONS