

APPROVED: \_\_\_\_\_  
 DATE: \_\_\_\_\_ TITLE: \_\_\_\_\_

Rev	AWO #	Description	Date	Appr
-		RELEASED	5/10/19	
A		UPDATE DRAWING	6/17/19	OW/RC
B		UPDATE DRAWING	7/21/20	OW/RC
C		UPDATE DRAWING	6/15/22	WX/TY

3.30mm Length

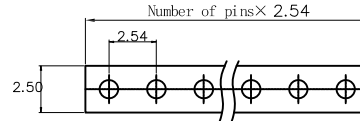
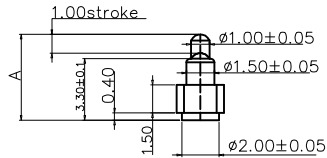

3.30mm Length

ADAM P/N	Initial Height
PH1-3B-XX-MVF-3345	4.5mm
PH1-3B-XX-MVF-3350	5.0mm

4.30mm Length

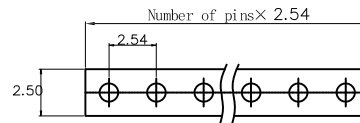
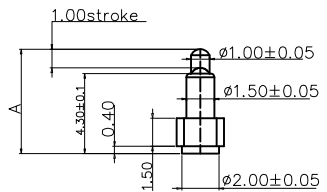

4.30mm Length

ADAM P/N	Initial Height
PH1-3B-XX-MVF-4355	5.5mm
PH1-3B-XX-MVF-4360	6.0mm

5.30mm Length

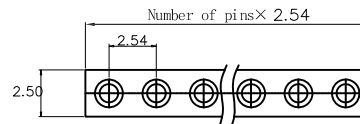
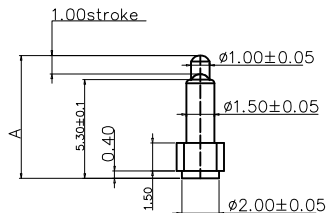

5.30mm Length

ADAM P/N	Initial Height
PH1-3B-XX-MVF-5365	6.5mm
PH1-3B-XX-MVF-5370	7.0mm
PH1-3B-XX-MVF-5375	7.5mm
PH1-3B-XX-MVF-5380	8.0mm

**SPECIFICATIONS:**

**Material:**  
 Insulator: PA46, rated UL 94V-0, Color: Black  
 Contacts: Copper Alloy, Gold flash plated  
 Contact solder area plating: Copper Alloy, 5u" Gold plated  
 Spring: SUS304  
**Electrical:**  
 Voltage rating: 12 Volts  
 Current rating: 1A max (3.30mm), 3A max (4.30&5.30mm)  
 Contact resistance @ working stroke: 20 mohms max. before test  
 60 mohms max. after test

Insulation resistance: 100 Mohms min  
 Dielectric withstanding voltage: 100 VRMS @ 60HZ

**Mechanical:**  
 Spring force: 90±20gf @ 1.0mm working stroke (3.30mm)  
 70±20gf @ 1.0mm working stroke (4.30 & 5.30mm)

Full stroke: 1.40mm  
 Life test: 10,000 Cycles Min  
 Temperature Rating:  
 Operating temperature: -30°C to +85°C

**Environmental:**  
 Lead free, RoHS compliant.

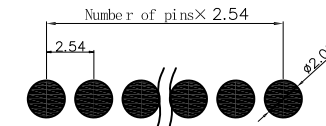

RECOMMENDED PCB LAYOUT

UNLESS OTHERWISE SPECIFIED ALL DIMENSIONS ARE MILLIMETERS. TOLERANCES: EXCEPT AS NOTED			
MM		ANGLE	
.X	± .20	X	±2°
.XX	± .15	.X	±.5°
.XXX	± .10		



909 Rahway Avenue,  
 Union, NJ 07083  
 Phone: 908-687-5000  
 Fax: 908-687-5710

DRAWN	OW	5/10/19
CHECKED	AC	5/10/19
APPROVED		

TITLE  
**CUSTOM LENGTH TUBE SINGLE ROW STRIPS**  
 1.50MM INSULATOR HEIGHT, SMT LOADED

THIS DRAWING CONTAINS INFORMATION THAT IS PROPRIETARY AND SHOULD NOT BE USED WITHOUT PRIOR WRITTEN PERMISSION FROM ADAM TECH

SIZE X	PART NO. PH1-3B-XX-MVF-XXXX	REV. C
REF: S00185C	SCALE: NTS	SHEET 1 OF 1