

Mechanical Dimensions: Inches [mm]

Tolerances ± 0.012 [0.3] Unless Otherwise Specified

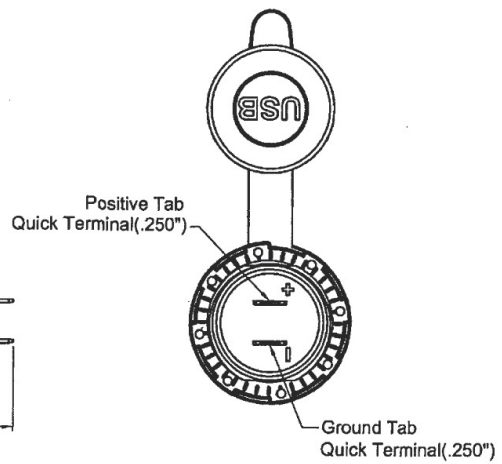

Mounting Hole

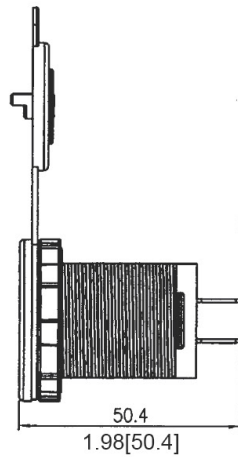
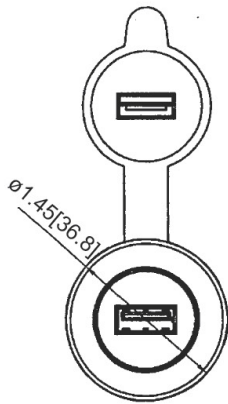
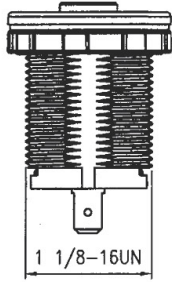
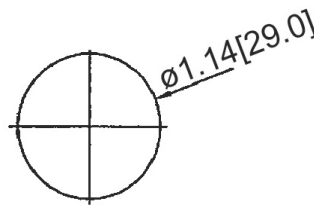

Electrical Specifications

Input Rating	12/24V
Output Rating (12VDC Input)	Type A output: 5V 2.1A
Output Rating (24VDC Input)	Type A output: 5V 2.1A
Insulation Resistance	DC 500V 100M ohms
Dielectric Strength	AC 1500V 1 min
Operating Temperature	-20°C ~ 45°C
Includes OVP, OCP, OTP, SCP, and RPP	

Material Specifications

	LED power indicator inside
Housing	Nylon with Fiberglass (UL94-HB), Black
Cap	PVC

Rev	Date of issue	Revision Notes	Designed	Approved
C	05-05-25	Initial Drawing	RC	OF