

## Mechanical Dimensions: Inches [mm]

Tolerances  $\pm 0.012$  [0.3] Unless Otherwise Specified

## Mounting Hole

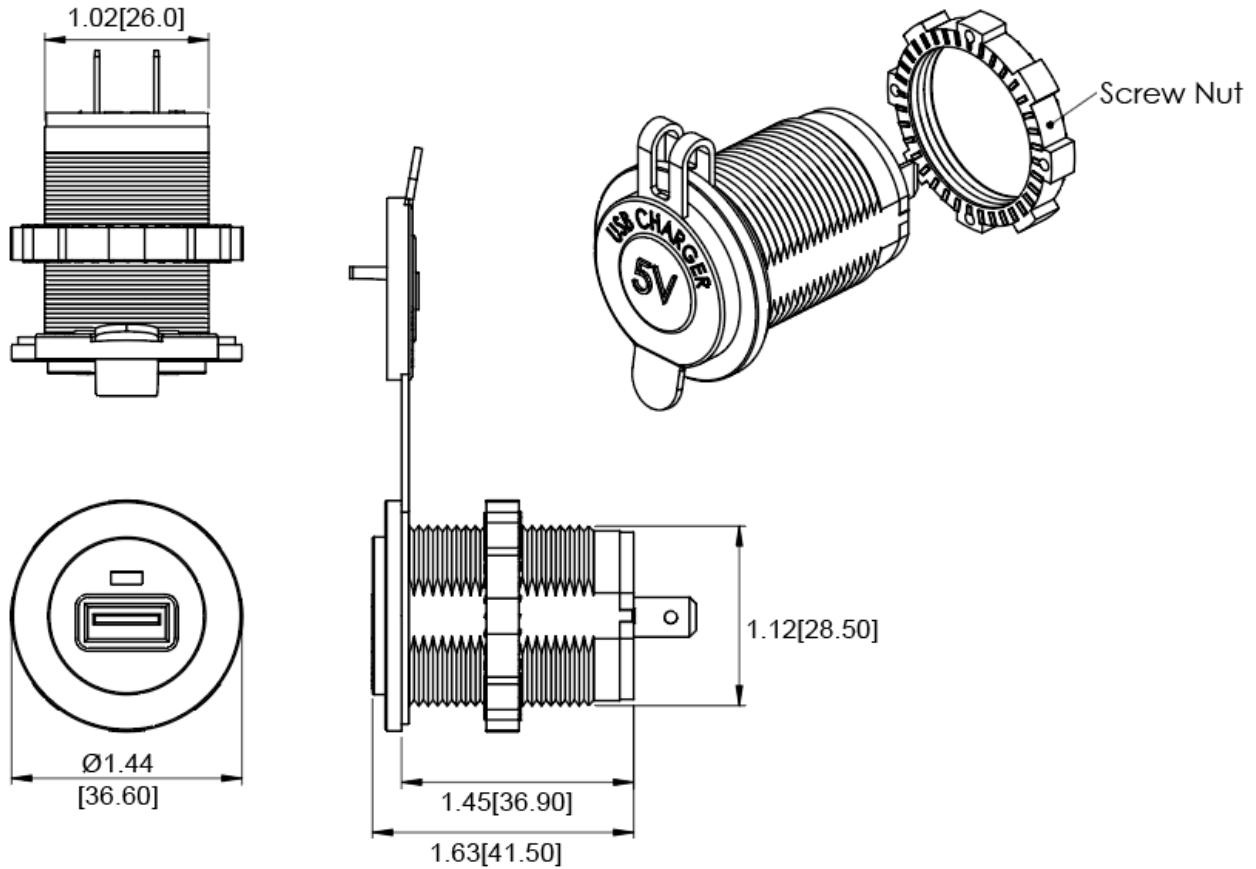
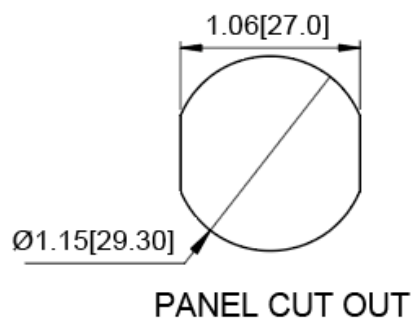

## Electrical Specifications

Input rating	12-24 VDC
Output rating (12VDC input)	Type A output: 5V 2.4A
Output rating (24VDC input)	Type A output: 5V 2.4A

Includes OVP, OCP, OTP, SCP, and RPP

## Material Specifications

LED Power Indication	
Body Material	Flame Retardant Nylon (Glass Fiber Reinforced)
Terminal Size	0.25" Quick Connect
Ingress Protection	IP66 (When not in use and cap is securely closed)
Type A USB	

# Power Adapter - USB Socket

## A8-USB1-1-BN-2.4A



Rev	Date of issue	Revision Notes	Designed	Approved
D	05-09-2025	Initial Drawing	RC	OF