

**Mechanical Dimensions: Inches [mm]**

Tolerances  $\pm 0.012$  [0.3] Unless Otherwise Specified

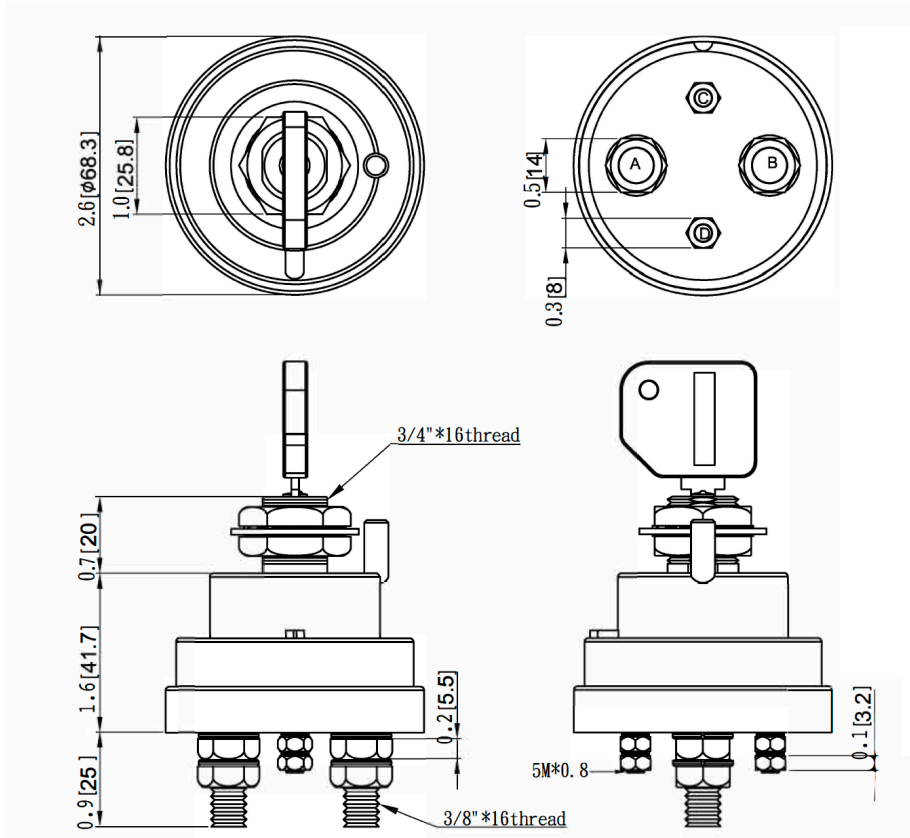

**Mounting Hol**

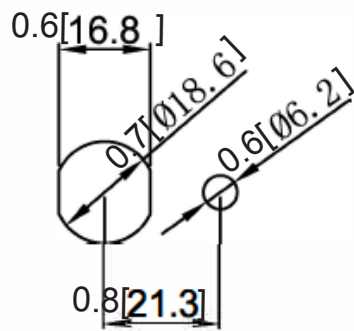

**Circuit Diagram**

**DPST:** For battery and alternator or generator field circuit.

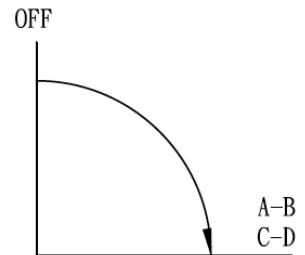

**Electrical Specification**

Continuous Rating	180A 6-36VDC (Large Studs), 20A 6-36VDC (Small Studs)
Intermittent Rating	1000A for 15secs intervals
Insulation Resistance	DC 500V 100M ohm Min
Dielectric Strength	AC 1000V 1 minute
Operating Temperature	-40°C~85°C

**Material Specification**

Construction	Zinc diecast construction
Sealing	Sealed with O-rings at base and mounting stem
Terminals	Copper, Silver plated terminals
Ingress Protection	IP65

# Battery Disconnect HDB3-2A-3-C1



Rev	Date of issue	Revision Notes	Designed	Approved
A	11-12-2019	Initial Drawing	RC	OF