

Surge-Trap® Pluggable SPD Three Pole - Data Sheet



Fail-Safe

Cost Effective

TPMOV® Technology



No Fuse Required

TPMOV®
TECHNOLOGY
By Ferraz Shawmut

Application

For Three Pole Applications & Systems
STP2083PYGM, STP2403PDGM, STP4803PDGM,
STP4803PYGM, STP6003PYGM

The Surge-Trap Pluggable SPD provides advanced overvoltage protection by utilizing Ferraz Shawmut's patented TMOV design, which does not require fuses, a fuse holder or additional wiring in meeting the UL 1449 Third Edition standards thus providing **substantial cost savings** and reduced installation times.

The Surge-Trap Pluggable SPD base is designed to be mounted on 35mm DIN-rail while plugs are easily replaceable upon failure without touching the base or the hassle of rewiring. It also features a visual indicator, easy installation, **fail-safe design**, mechanical coding and remote monitoring.

System Information

Surge-Trap Pluggable Systems (includes base and plugs)	STP2403PDGM	STP4803PDGM	STP2083PYGM	STP4803PYGM	STP6003PYGM
Nominal Voltage (Vac)	240D	480D	120/208	277/480	347/600
MCOV (Vc) L-G	275	550	180	320	420
Phase	3 Phase Delta	3 Phase Delta	3 Phase Wye	3 Phase Wye	3 Phase Wye
Number of Poles	3	3	3	3	3
Number of Wires	4	4	4	4	4
Nominal Discharge Current (In, kA)	20	10	20	20	10
Max. Discharge Current (Imax, 8/20, kA)	50	50	50	50	50
SCCR (kA)	200	200	200	200	200
Freq (Hz)	50/60	50/60	50/60	50/60	50/60
Voltage Protection Rating (L-N)	900 (L-G)	1800 (L-G)	600	1000	1500
Replacement Plug Part No	SP275U	SP550U	SP180U	SP320U	SP420U
Application	UL Type 2				
Standard	UL 1449 3rd Edition				

More on Reverse ➡

Surge-Trap® Pluggable SPD Three Pole - Data Sheet

For **Three Pole** Applications & Systems

STP2083PYGM, STP2403PDGM, STP4803PDGM, STP4803PYGM, STP6003PYGM

Wiring Diagram

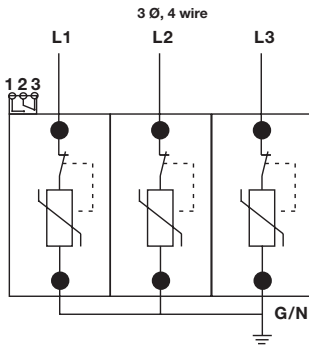

Base & Voltage Key Orientation

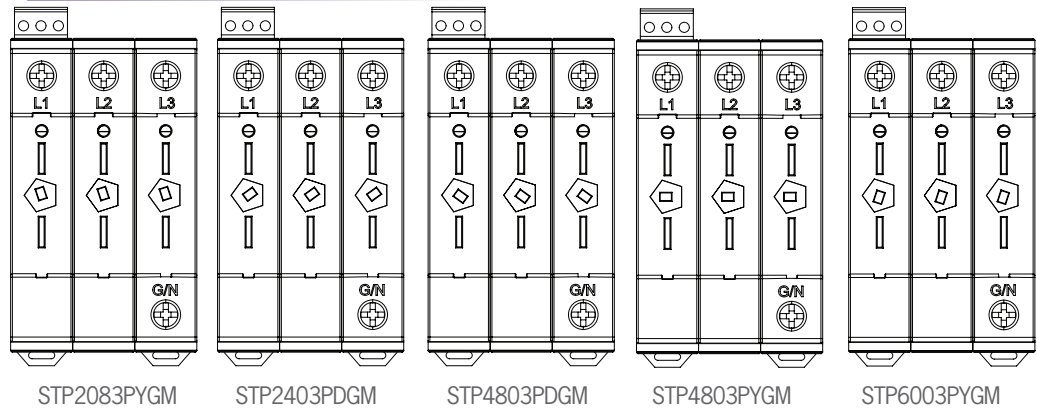

Wire Installation

#6 – #14 AWG, 60/750C Copper wire shall be used. Maximum torque to be applied to terminal screws is 2.0 newton-meter (14.75 in-lb). Strip back wire insulation 6mm (1/4").

Base Measurements

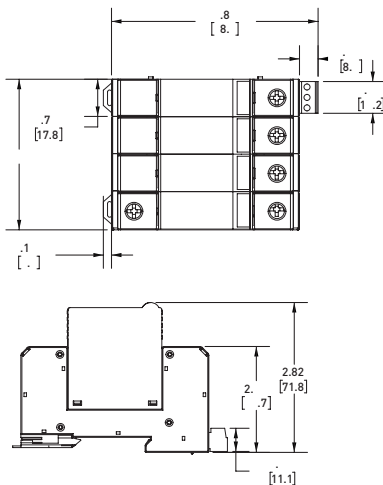

Poles	A
1 Pole	18.03 mm
2 Pole	36.06 mm
3 Pole	54.10 mm
4 Pole	72.13 mm

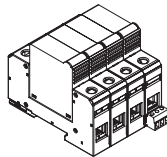

Plug Measurements

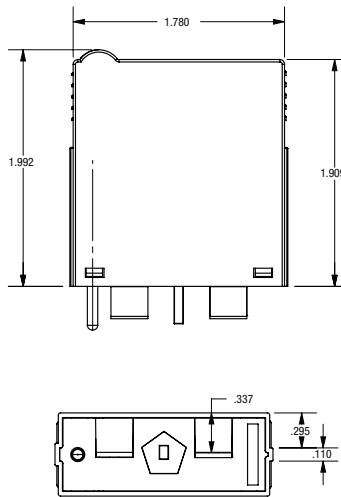

TPMOV®
TECHNOLOGY
By Ferraz Shawmut



For more information, visit us at:

Ferraz Shawmut | North America
374 Merrimac Street
Newburyport, MA 01950
T: 978-462-6662
F: 978-462-0181

Microswitch Details

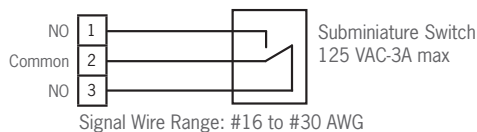
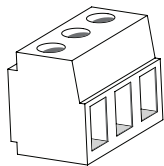

- > Terminal Torque 2.2 lb-in
- > Cont. between Comm + NO = Product Offline, Not Protected
- > Cont. between Comm + NC = Product Offline, Protected

Auxiliary Micro-Switch Installation

Remote signaling is available on all Surge-Trap products that specify a remote indicator. #16 – #30 AWG signal wire may be used. The maximum continuous current rating for the remote indicator is 3A.

Ferraz Shawmut | Canada
88 Horner Avenue
Toronto, Ontario, Canada M8Z 5Y3
T: 416-252-9371
F: 416-252-6572

© 2010 Ferraz Shawmut. All rights reserved.



DS-STP-3Pole | 5000 | 2.10 | Growll

