

Surge-Trap® Pluggable SPD **Four Pole** - Data Sheet



Fail-Safe

Cost Effective

TPMOV® Technology



No Fuse Required

TPMOV®
TECHNOLOGY

By Ferraz Shawmut

Application

For Four Pole Applications & Systems
STP2083PYM, STP4803PYM, STP6003PYM,
STP2403PHM, STP4803PHM

The Surge-Trap Pluggable SPD provides advanced overvoltage protection by utilizing Ferraz Shawmut's patented TPMOV design, which does not require fuses, a fuse holder or additional wiring in meeting the UL 1449 Third Edition standards thus providing **substantial cost savings** and reduced installation times.

The Surge-Trap Pluggable SPD base is designed to be mounted on 35mm DIN-rail while plugs are easily replaceable upon failure without touching the base or the hassle of rewiring. It also features a visual indicator, easy installation, **fail-safe design**, mechanical coding and remote monitoring.

System Information

| Surge-Trap Pluggable Systems (includes base and plugs) | STP2083PYM | STP4803PYM | STP6003PYM | STP2403PHM | STP4803PHM |
|--|---------------------|----------------|----------------|------------------|------------------------|
| Nominal Voltage (Vac) | 120/208 | 277/480 | 347/600 | 120/240 | 240/480 |
| MCOV (Vc) L-G | 360 | 500 | 695 | * | * |
| Phase | 3 Phase Wye | 3 Phase Wye | 3 Phase Wye | 3 Phase High Leg | 3 Phase High Leg |
| Number of Poles | 4 | 4 | 4 | 4 | 4 |
| Number of Wires | 5 | 5 | 5 | 5 | 5 |
| Nominal Discharge Current (In, kA) | 20 | 20 | 10 | 20 | 10 |
| Max. Discharge Current (Imax, 8/20, kA) | 50 | 50 | 50 | 50 | 50 |
| SCCR (kA) | 200 | 200 | 200 | 200 | 200 |
| Freq (Hz) | 50/60 | 50/60 | 50/60 | 50/60 | 50/60 |
| Voltage Protection Rating (L-N) | 600 | 1000 | 1500 | 600 | 900 |
| Replacement Plug Part No | SP180U | SP320U, SP180U | SP420U, SP275U | SP180U, SP275U | SP275U, SP550U, SP180U |
| Application | UL Type 2 | | | | |
| Standard | UL 1449 3rd Edition | | | | |

* Call for Information

More on Reverse ➔

Surge-Trap® Pluggable SPD Four Pole - Data Sheet

For **Four Pole** Applications & Systems

STP2083PYM, STP4803PYM, STP6003PYM, STP2403PHM, STP4803PHM

Wiring Diagram

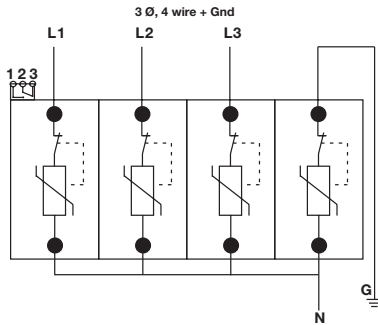

Base & Voltage Key Orientation

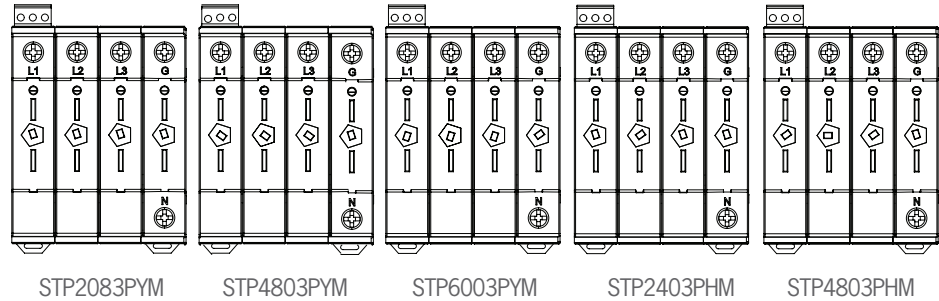

Wire Installation

#6 – #14 AWG, 60/750C Copper wire shall be used. Maximum torque to be applied to terminal screws is 2.0 newton-meter (14.75 in-lb). Strip back wire insulation 6mm (1/4").

Base Measurements

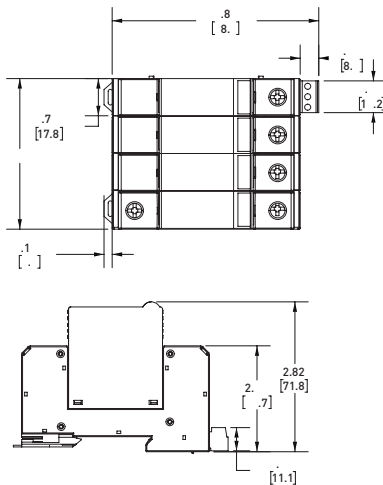

| Poles | A |
|--------|----------|
| 1 Pole | 18.03 mm |
| 2 Pole | 36.06 mm |
| 3 Pole | 54.10 mm |
| 4 Pole | 72.13 mm |

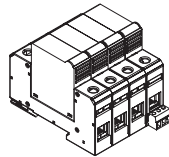

Plug Measurements

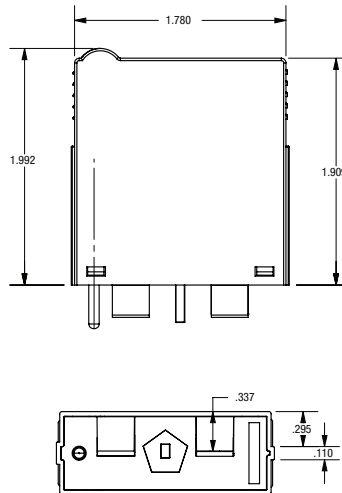

TPMOV®
TECHNOLOGY
By Ferraz Shawmut



For more information, visit us at:

Ferraz Shawmut | North America
374 Merrimac Street
Newburyport, MA 01950
T: 978-462-6662
F: 978-462-0181

Ferraz Shawmut | Canada
88 Horner Avenue
Toronto, Ontario, Canada M8Z 5Y3
T: 416-252-9371
F: 416-252-6572

© 2010 Ferraz Shawmut. All rights reserved.

Microswitch Details

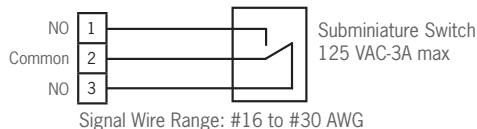
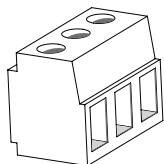

Signal Wire Range: #16 to #30 AWG
>Terminal Torque 2.2 lb-in
>Cont. between Comm + NO = Product Offline, Not Protected
>Cont. between Comm + NC = Product Offline, Protected

Auxiliary Micro-Switch Installation

Remote signaling is available on all Surge-Trap products that specify a remote indicator. #16 – #30 AWG signal wire may be used. The maximum continuous current rating for the remote indicator is 3A.



DS-STP-4Pole | 5000 | 2.10 | Growll

