

KYCON, Inc. 1810 Little Orchard Street, San Jose, CA 95125 (408)494-0330

Riveted Threaded Inserts  
with 4-40 UNC Jackscrews  
Installed

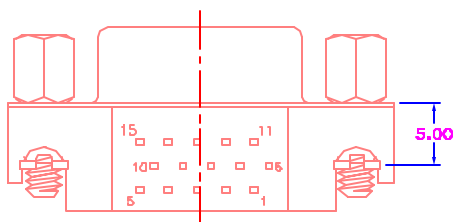

Recommended P.C.B. Layout  
(Top View)

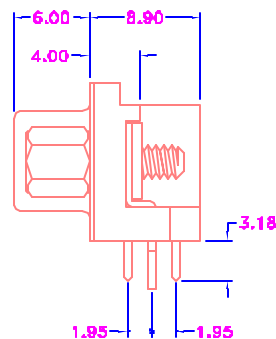
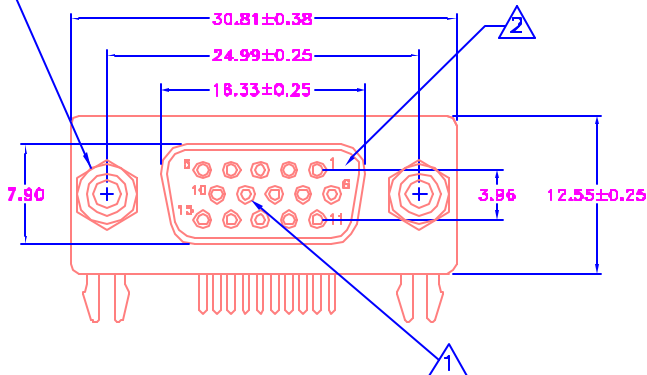
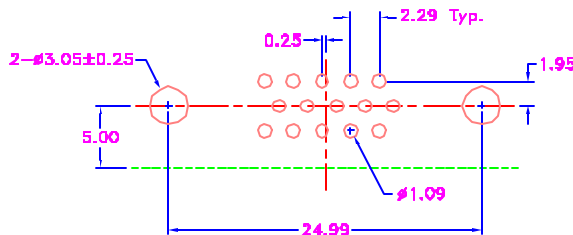

1 Contact #9 Recessed 0.050" [1.27mm]  
Shorter contact allows last mate/first  
break on 5V supply voltage

2 Blue body color signifies 5v  
capability and full feature  
AccessBus capability

### Material And Finish

Shell: Steel Material, Tin Plated  
or Zinc Plated

Insert: PBT Thermoplastic,  
UL-94V-0 Rated,  
Blue Color

Contact Material:  
Socket- Phosphor Bronze

Contact Plating:  
-15 Option:  
15u" Gold over Nickel on  
contacts, Tin/Lead over  
Nickel on solderfalls

### Electrical Specifications

Contact Current Rating:  
5A

Rated Voltage:  
300V DC

Withstanding Voltage:  
500V (rms) AC for 1 min

Insulation Resistance:  
more than 1000 Megohm  
at 50v DC

Contact Resistance:  
13 milliohm Max

Dielectric Strength:  
1000V for 1 min

Operating Temperature:  
-55°C to +105°C

#### Tolerances

X.X ± 0.5  
X.XX ± 0.2  
Unless Stated  
Otherwise

CSA NRTL/C Certified File No. LR7816D

REVISION	DATE	DESCRIPTION	DRAWN BY	DESIGNED BY	UNITS
A	2/11/99	New Drawing	C. LeMa		mm [in]
A2	7/15/99	Rev. Dimensions	CHECKED BY	APPROVED BY	DATE
A3	11/10/00	ECD #99-193			2/11/99

K61-E15S-NJ15-VESA

15 pin High Density Female VESA D-Sub  
Compact Footprint

