

PCB LAYOUT/TOP VIEW

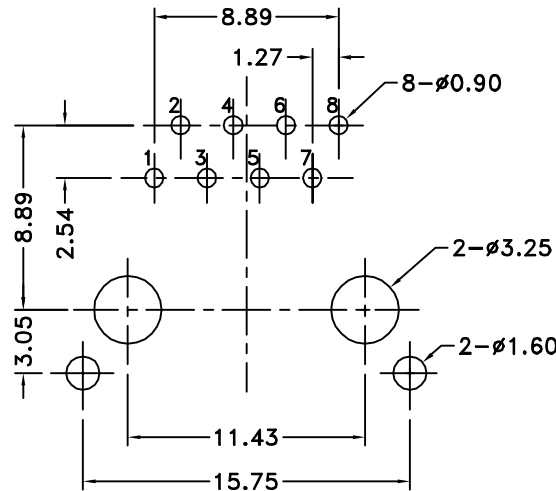

Part Number	Contact Plating Finish
GDLF-SA-88-50	50u" Gold

Materials and Finish

Housing Material—
PBT Thermoplastic
UL 94V-0 Rated
Color: Black

Shield Material—
Copper Alloy— Tin or Nickel Plated

Contact Material—
Phosphor Bronze

Contact Plating Options—
50 Option: 0.0001" Nickel Plating,
Selective Plating 0.000050"
Gold on Contact Area to
Comply with FCC Requirements
Under No. 47 C.F.R. Part 68,
Subpart F

Electrical Characteristics

Insulation Resistance—
500 Megohms Min.

Dielectric Withstanding Voltage—
1000V rms, 60Hz

Contact Resistance—
20 milliohms Max.

Current Rating—
1.5 Amps

Ferrite Specifications	
Test Frequency	Impedance
1 Mhz	1 ohm
10 Mhz	7 ohms
30 Mhz	13 ohms
50 Mhz	16 ohms
100 Mhz	21 ohms

CSA NRTL/C Certified File No. LR78160

REVISION	DATE	DESCRIPTION	DRAWN BY	DESIGNED BY	UNITS
A04	1/15/01	reverse & correct boardlock orientation on bottom view, change shield plating to tin or nickel	C. Leiva		mm
A1	5/14/01	release drawing	CHECKED BY	APPROVED BY	DATE
A2	10/3/01	Ref ECD 01-150		W. Wuerth	11/6/00

GDLF-SA-88-50

Shielded Mod. Jack, 8 pos. 8 contacts

Angled Grounding Flaps, Ferrite Filter

