

Recommended PCB Layout  
(top view)

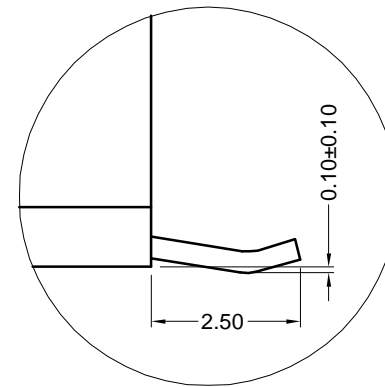

DETAIL A

**Materials and Finish**

Housing Material:  
high temp. thermoplastic,  
(reflow process compatible)  
UL 94V-0 rated, black color

Recommended Reflow Temperature:  
230°C for 30 seconds,  
260°C max.

Design meets UL 1863 Sec. 8  
Electrical Probe and Sec. 20  
Child Finger test requirements

Contact Material: phosphor bronze

Contact Plating Options:  
Standard: 0.0001" Nickel  
Plating, Selective Plating  
Gold Flash on Contact  
Area, Tin/Lead on Termination End  
-50 Option: 0.0001" Nickel Plating,  
Selective Plating 0.000050"  
Gold on Contact Area to  
Comply with FCC Requirements  
Under No. 47 C.F.R. Part 68,  
Subpart F, Tin/Lead on  
Termination End

**Electrical Characteristics**

Insulation Resistance:  
500 Megohms min.

Dielectric Withstanding Voltage:  
1000V rms, 60Hz

Contact Resistance:  
20 milliohms max.

Current Rating: 1.5 Amps

Durability Rating:  
1000 mating cycles min.

Operating Temperature:  
-40°C to +85°C

Part Number	Contact Area Plating	Packaging
GM-SMT4-N-88	Gold Flash (standard)	Bulk
GM-SMT4-N-88-50	50u" Gold (50 option)	
GM-SMT4-N-88-TR	Gold Flash (standard)	Tape & Reel
GM-SMT4-N-88-50TR	50u" Gold (50 option)	



Tolerances
X.X ± 0.38
X.XX ± 0.25
Unless Stated Otherwise

REVISION	DATE	DESCRIPTION	DRAWN BY	DESIGNED BY	UNITS
A4	1/11/02	Release DWG	E. Cruz		mm
A5	3/25/02	ECD #01-199	REVISED BY	APPROVED BY	DATE
A6	6/5/02	ECD #02-038	C. Leiva		2/22/01

GM-SMT4-N-88

Right Angle Modular Jack--No Pegs  
8 position, 8 contacts, Surface Mount

