

# Type BLC-20A Fuse Block For 1/4" x 1 1/4" (6.3 x 32mm) Fuses



www.optifuse.com

(619)-593-5050

**Fuse Style:** 1/4" x 1 1/4" (6.3 x 32mm) Fuses

**Material:**

**Body:** PBT (UL Flame: 94V-0)

**Terminal:** Nickel plated Brass

**Mounting:** by screws

**Electrical:** 15A 125VAC  
10A 250VAC

Single Fuse Blocks can be snapped together for multi-pole applications.

**Agency Standards and Listings:**



**Product Dimensions: Inches [mm]**

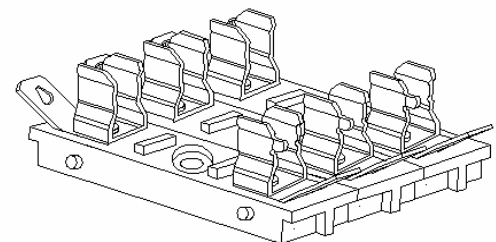
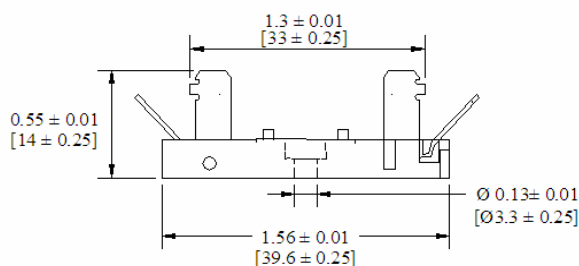
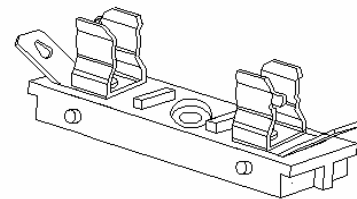
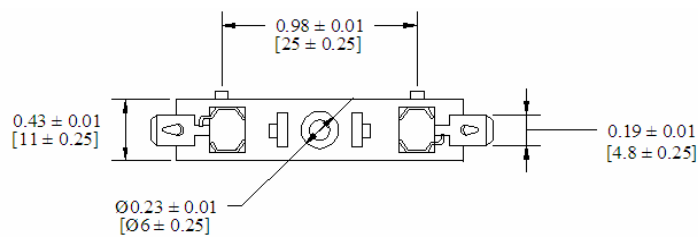

**Warning:**



-Operation beyond the specified maximum ratings or improper use may result in damage and possible electrical arcing and/or flame.

-Avoid contact of Fuse Block with chemical solvent. Prolonged contact may damage the device performance.